

# 180 degrees peeling table P180-200N

Best for peeling test at 180 degrees.

1. Suitable for 180 degrees peeling test
2. For peeling measurement according to standard (JIS)

P180-200N



Feature 1	Feature 2	Feature 3
Simple test of 180 degree Peeling	Adjustable peeling angle	Meets JIS
Suitable for various materials of 180 degree peeling test because of its simple and easy operation.	Set table position (in front and back) to adjust peeling angle easily.	It meets Japanese Industrial Standards, JIS Z0237 (Testing methods of pressure-sensitive adhesive tapes and sheets).

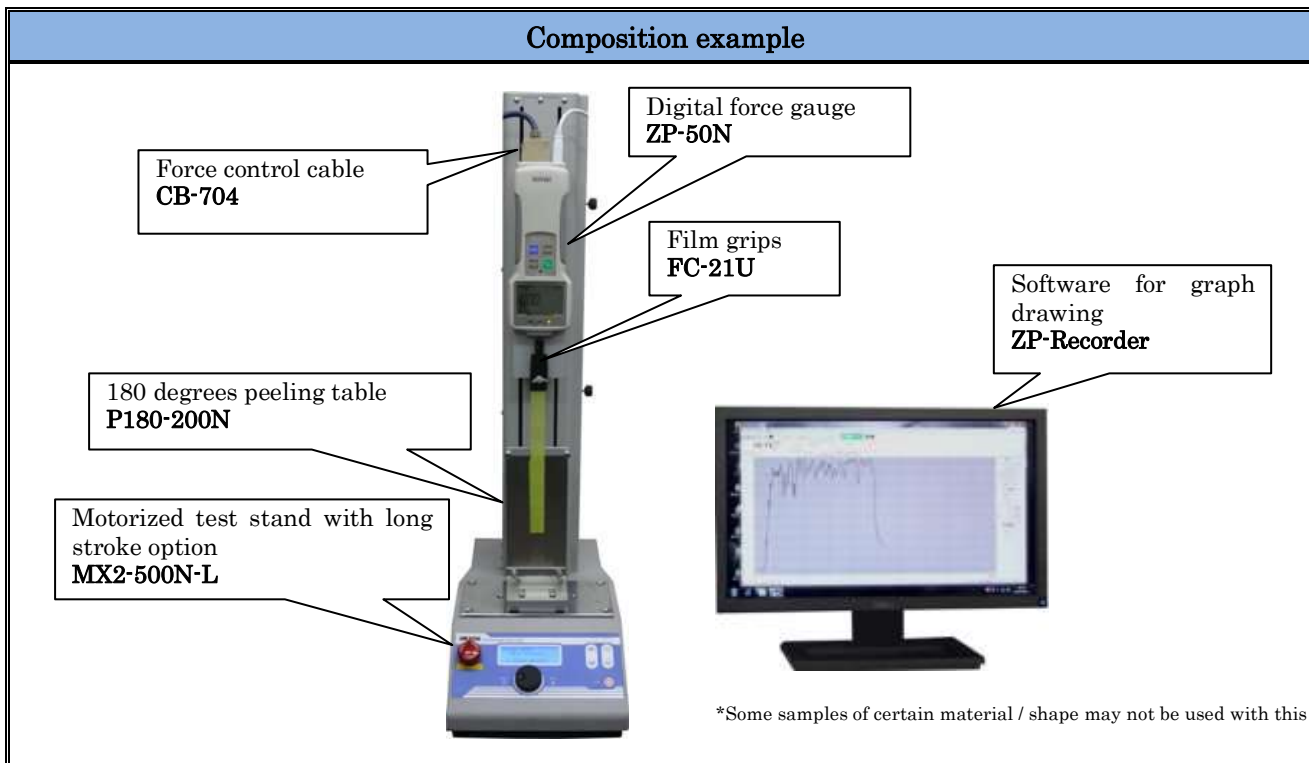

	180 degrees peeling table	Digital force gauge	Software for graph drawing	Cable for force control	Motorized test stand	Film grips
<p><b>Case 1</b> [Standard measurement]</p> <p>To analyze the whole measurement by drawing graphs.</p>	[P180-200N]	[ZP series] *1	[ZP-Recorder]	[CB-704] *2	[MX2-500N-L] *3	[FC series]
<p><b>Case 2</b> [Economy measurement]</p> <p>To analyze the whole measurement by drawing graphs.</p>		[DS2 series] *1	[N/A]	[N/A]		

\*1 It is appropriate to use Digital Force Gauge is recommended for adhesion test.

\*2 We suggest using cables to avoid over load. (Available only with ZP/Z2 series)

\*3 Motorized Test Stand is suitable for adhesion test. We especially recommend using MX2 series with which test speed can be set.

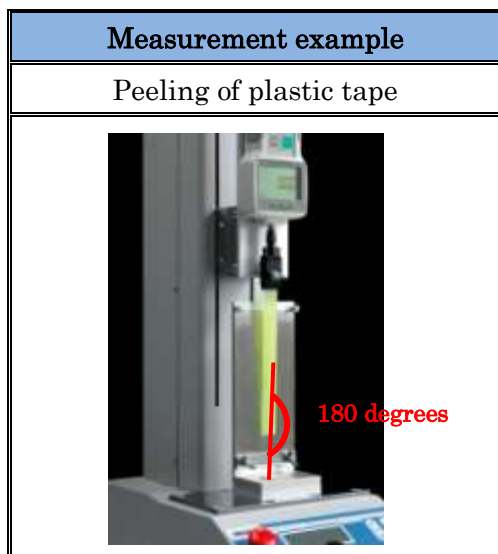



Specifications	
Model	P180-200N
Length (sample)	150mm
Width (sample)	40mm
Capacity	0.5~200N
Dimensions	See page 4
Weight	Approx. 300g
Fixable test stand	MX-500N-L, MX2-500N-L MX-1000N-L, MX2-1000N-L, EMX-1000N-L

\* Contact us in case using with other models of test stand.

\* Special adapter is required to fix EMX-1000N-L.

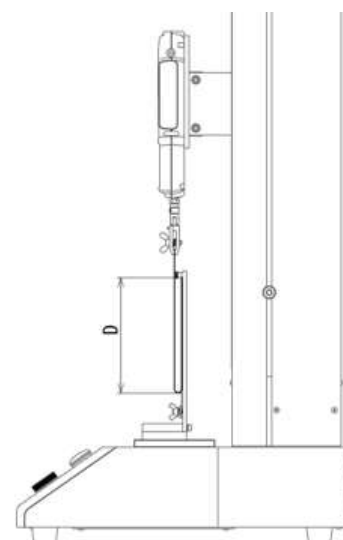
Peeling stroke by each test stand models	
Test stand	Peeling stroke (D)
MX2-500N-L	Approx. 70mm
MX2-1000N-L	150mm (Full stroke of peeling table)
EMX-1000N-L	150mm (Full stroke of peeling table)
MX-500N-L	Approx. 120mm
MX-1000N-L	150mm (Full stroke of peeling table)
MX-2000N-L	Approx. 140mm



Option	
<b>Weight roller</b> <b>APR-97</b> (Meets JIS Z0237)	<b>Spare stainless panel</b> <b>SSP-1608</b>
	
It helps to stick samples on the panel with stable force, which leads stable measurement result. (Meets JIS Z0237)	Needless to take off and wash the panel after every measurements, if you have spare panel. It helps save time and work.

[Dimensions]

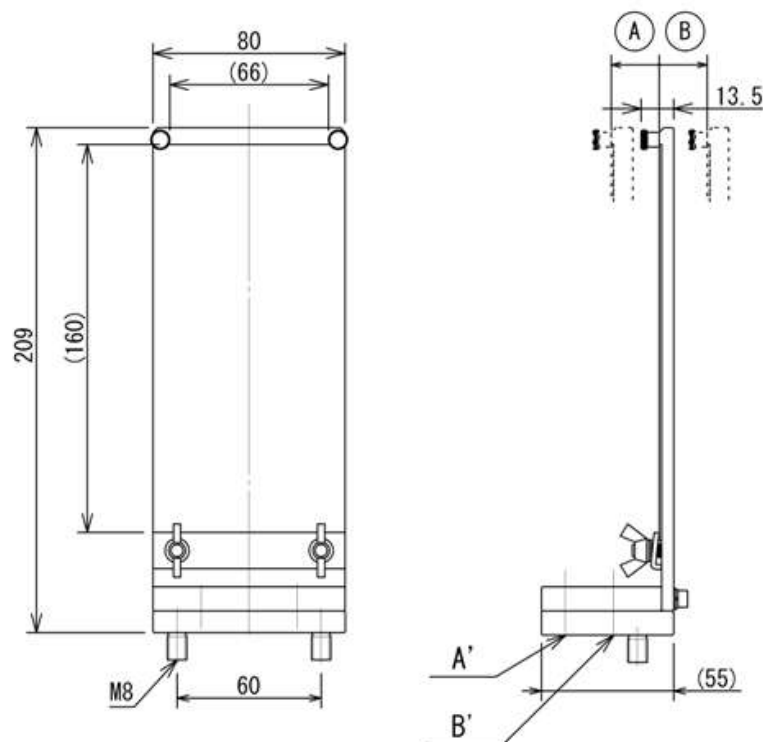

Ⓐ	+20mm	To set position A'
Ⓑ	-20mm	To set position B'

[Cautions]

- \* The contents may be changed without notice in advance.
- \* Force gauge, test stand and grips are needed to have force measurement.
- \* This product is designed for measurement purpose only.
- \* Do not copy and the contents without permission.