

---

Flat Chucks / GC-1001, 1021, 5000

## Wide range type

For both thin and thick samples

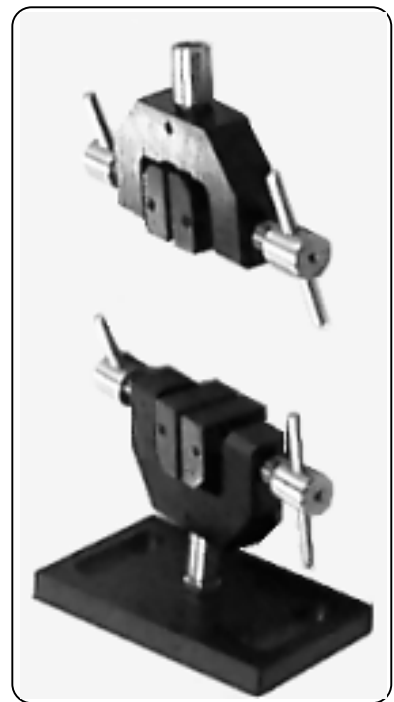
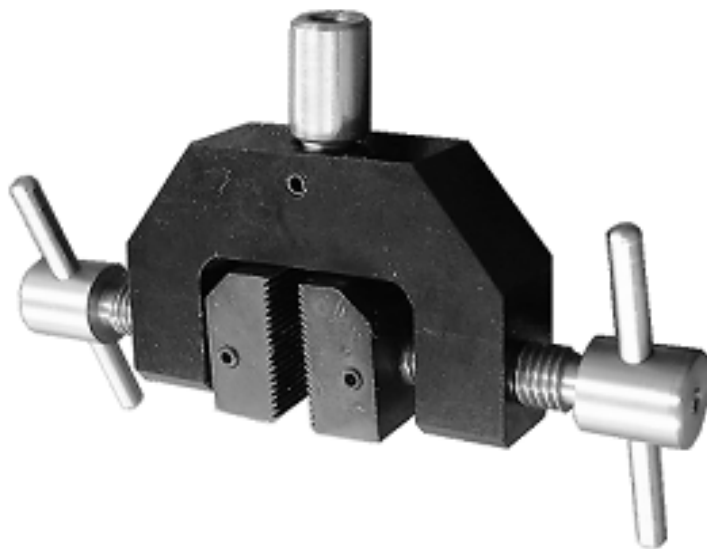

### [Applications]

The flat chucks are installed on the Imada's force gauge for tension test of various test pieces.

### [Feature]

They are suitable for checking both thin and thick materials.

Wide model GC-1021 is also available.

## [Specification]

Model	GC-1001	GC-1021	GC-5000
Type	Normal	Wide	High Capacity
Capacity	1000N	1000N	5000N
Mounting Screws[S]	M6P1	M6P1	M10P1.5
Weight	150 g	158 g	1400 g
Dimension (W×H×D)	56×(51)×20 mm	66×(51)×20mm	104×(92)×30 mm
Inside[A]	20mm	42mm	64mm
Opening width [B]	MAX 10mm	MAX 20mm	MAX 30mm
Width of Chuck [E]	20mm	20mm	29mm
Height of Chuck [F]	20mm	20mm	37.5mm
With Force Gauge	PS/FB/DPS/DPX/DPZ 20N~	PS/FB/DPS/DPX/DPZ 20N~	PSH/DPSH/DPZH 200N~

## [Dimension]

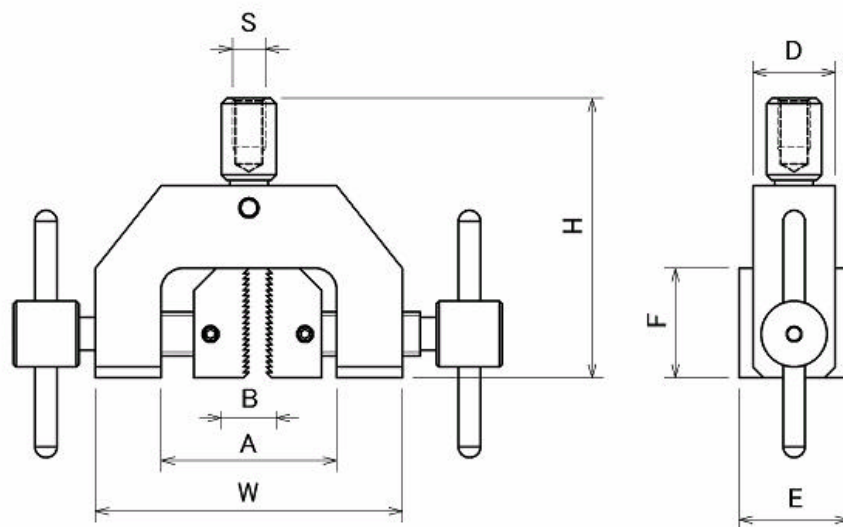

## [Dimension of Grip]

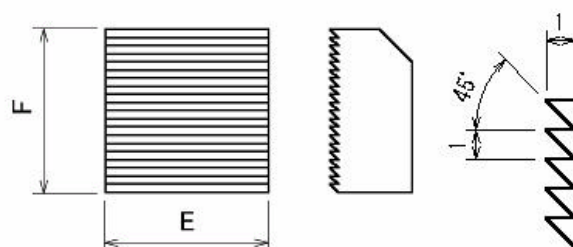

## [Note]

- Particular materials and shape can not be used.
- Combining with Imada's test stand, more stable measuring becomes possible.
- All information is subject to change without prior notice.