

[ LH-50]

## Wire Harness Pull Tester



LH-50  
(Force gauges are sold separately.)

### [Application]

Measuring of caulking strength of the lead wire of wire harness

### [Feature]

Efficient measuring is possible by lever operation.

The slide is possible to adjust vertically for the clamper alignment.

## [LH-50 Specifications]

Model	LH-50	
Capacity	500N	
Stroke	Max 60mm	
Clamper	CW-50: Wire clasper (Fixed side on tester)	CH-50: Terminal clasper (Gauge side)
Wire clamp method	Eccentric cam lever	Grooved flat chuck
Dimension of clamp	W60xD50xH12 mm	W60xD20xH19 mm
Opening width	Max 10 mm	Max 5 mm (Gauge mount hole: M6)
Dimension	W516xD153xH(200)	
Weight	12.5Kg	
Accessory	Wire clamp CW-50 Wire chuck CH-50	

[Dimension]

LH-50

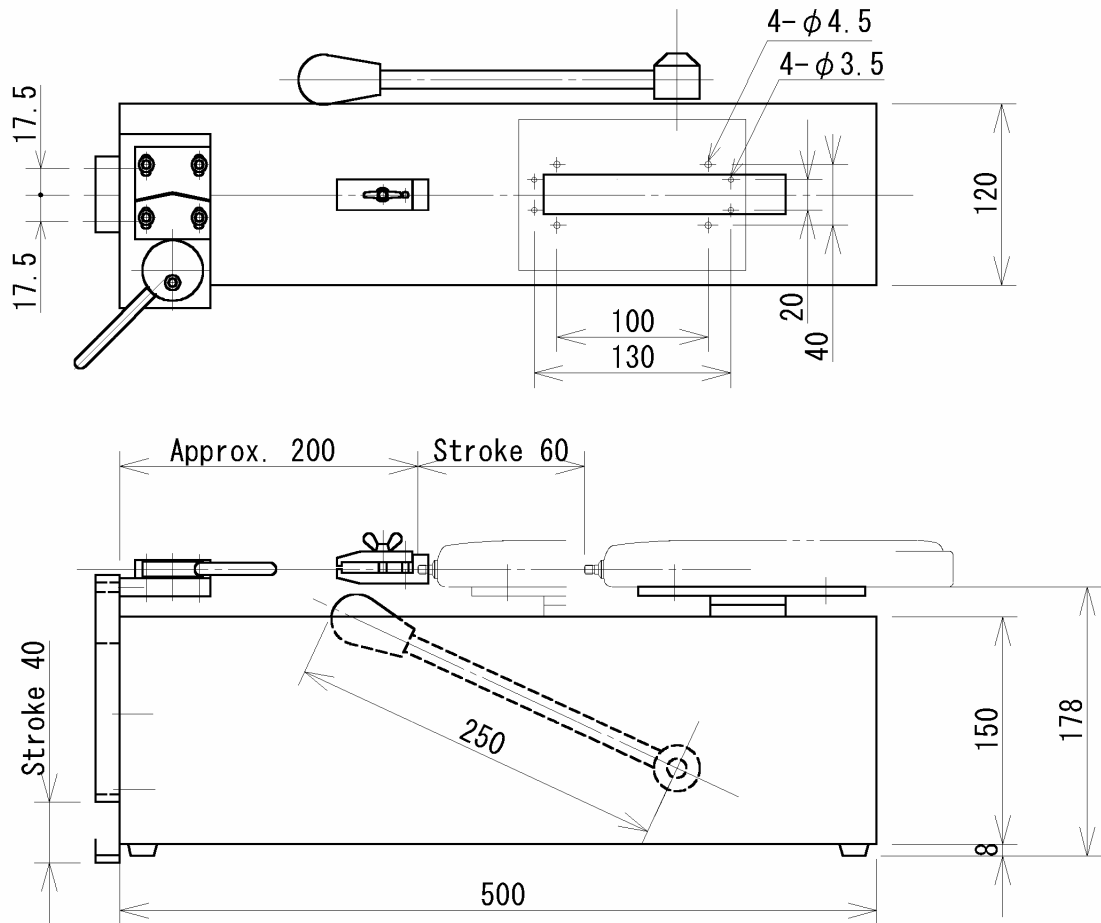

[Note]

Force gauge (sold separately) is required for actual measuring. Please order Imada products.  
 All information is subject to change without prior notice.