

X-Y Table / GT-20-3

Movable table for sample alignment



[Application]

- The X-Y table is used for alignment of various sheet switches when their contact presses are measured.

[Feature]

- The table can move ± 30 mm on X and Y directions.
- An additional attachment can be installed on the table with the 4 mounting threaded holes (M4).

[GT-20-3 specifications]

Model	GT-20-3
Stroke	X : +/-30 mm Y : +/-30 mm
Capacity	500N
Dimension	Refer to the dimensional drawing

[Dimensional drawing]

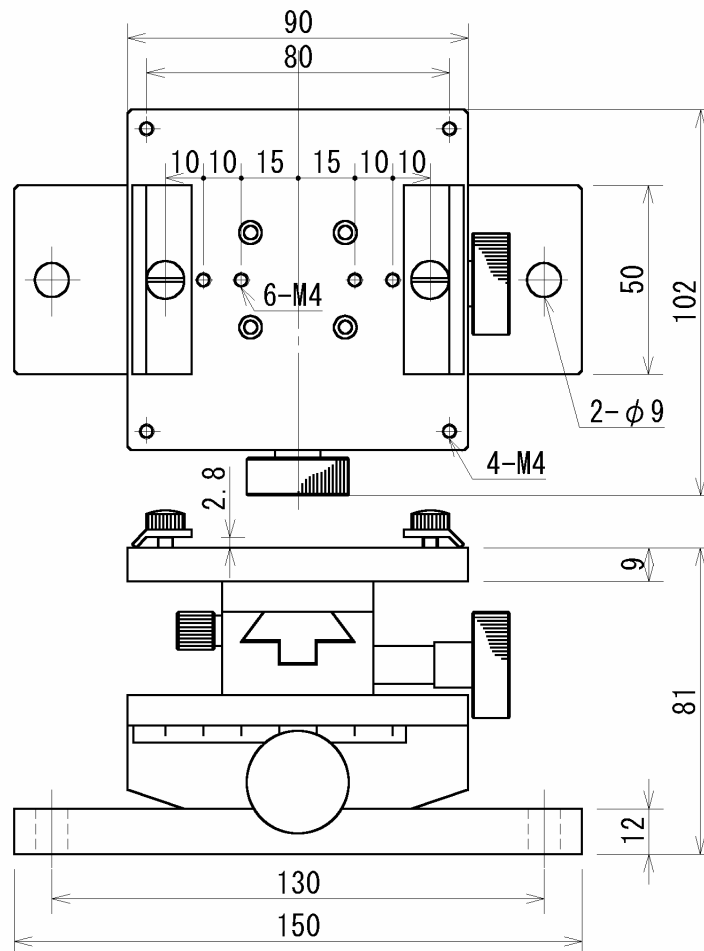

* Sample size : Max 60×60

[Precaution]

- All information is subject to change without prior notice.