

# Automatic Crimp Tester ACT-1000N

- Improves test efficiency with one-button operation, providing smooth flow from testing to data saving including OK/NG (pass/fail) judgement
- 2 modes selectable: BREAK mode and KEEP mode
- Capable of saving up to 26 test patterns, immediately recallable to suit various samples
- Complies with the corresponding part of UL and JIS standard

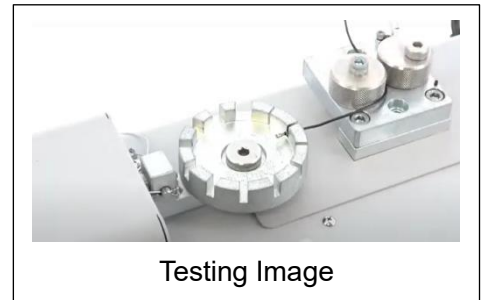

**ACT-1000N**

## [Evolution to the Next Series]

Next Series is a generic term for IMADA measurement devices with upgraded functions and performances with the essential modifications. The devices enable to install additional functions from the user support site, IMADA-Connected. On the website, related data such as instruction manuals can also be downloaded.

Next Series: ACT-1000N Firmware Ver.2.0 or later.

### New Features

-Increased measurement stability achieved from further noise reduction to the measurement circuit.

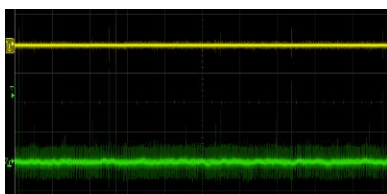

Internal analog wave comparison  
Yellow: Next series/Green: Old Model

- Measurement device program (firmware) online updates available.

- Additional functions and instruction manuals downloadable to increase the measurement conveniences.



IMADA-Connected

(<https://www.imada-connected.com/>)

Related Standard	<p><b>-JIS C 2805: 2010</b> [Crimp-type terminal lugs for copper conductors] (corresponding part only)</p> <p><b>-JIS C 5402-16-4: 2012</b> [Connectors for electronic equipment-Tests and measurements-Part 16-4: Mechanical tests on contacts and terminations-Test 16d: Tensile strength (crimped connections)] (corresponding part only)</p> <p><b>-UL 486A-486B: 2013</b> [Standard for Safety for Wire Connectors-9.3.4 Pullout test] (corresponding part only)</p>
------------------	---

Features				
Perfect solution for automatic crimp testing				
Simple sample setting by one hand	Returns automatically after testing	OK/NG (pass/fail) judgement	Saves data in PC or ACT-1000N	Saves up to 26 test patterns

### Selectable 2 testing modes

#### 1. BREAK mode for destructive test

It enables the test complying with the corresponding part of **JIS C 5402-16-4: 2012**.

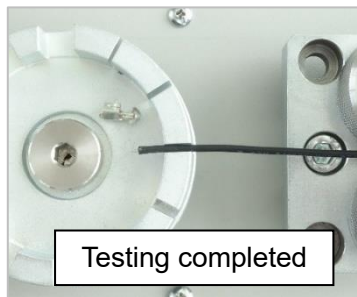
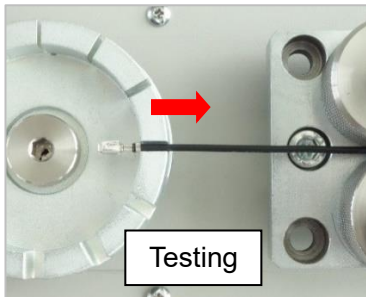

The display shows the judgment result and the peak force when the crimp terminal breaks.



Peak force

Judgement result

#### 2. KEEP mode for nondestructive test to apply specific force for set time

It enables the test complying with the corresponding part of  
**-JIS C2805: 2010** (Keep loading force for 10 sec or more at 25mm/min)  
**-UL 486A-486B: 2013** (Keep loading force for 60 sec or more)



Set the test condition to  
 [Keep loading 50N for 10 secs when pulling at 100mm/min]

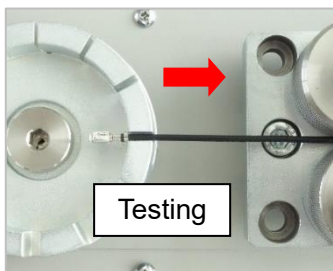

[Display when testing]



←Current force

←Pasted time

Set force ↑      ↑ Set time

F: Peak value  
T: Loading time

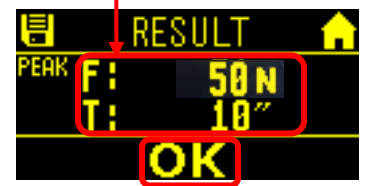

Judgement result

### User-friendly Structure

Broken terminals can be easily discarded by removing the jig from the body.

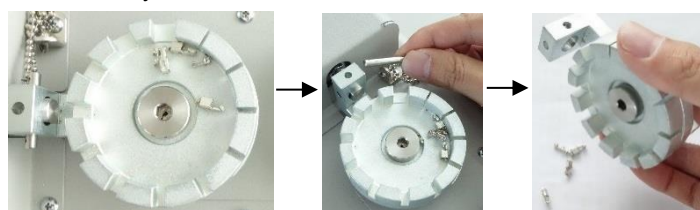

Increased the gripping area prevents the wire cover from tearing.

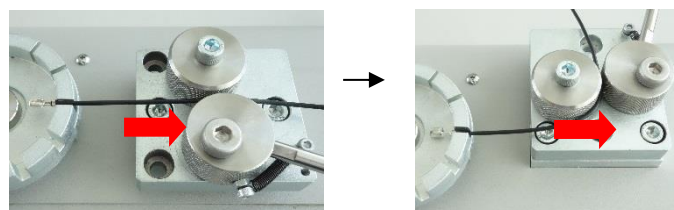

### Specification

Product Model	ACT-1000N	ACT-1000N-V300
Capacity	1000N	
Resolution	1N	
Accuracy	+/-0.5% F.S +/-1digit	
Unit	N, kgf, lbf (*1)	
Sampling rate	2000Hz	
Safe overload rating	Approx. 150% F.S.	
Overload warning	110% or less	
Measuring speed	10/25/50/100 mm/min (Adjustable from 4 step)	25/50/100/300 mm/min (Adjustable from 4 steps)
Stroke	Approx.50mm	
Allowable sample diameter	Terminal side: 1-8mm (*2)	
	Harness side: 1-8mm (*2)	
Allowable sample length	100mm or more	
Mode	BREAK/KEEP mode	
Allowable test conditions	26 patterns (A to Z)	
Output	USB/RS232C/pass or fail decision signal (OK/NG)	
Security lock	Emergency stop button and Overload prevention (at the power on)	
Power supply	AC100-240V	
Weight	Approx. 11kg	
Size	W400*D240*H150	
Operating environment	Temperature :0-40 degree Celsius, Humidity:20-80%RH	
Accessory	Software, USB cable, Power cord, Inspection Certificate	

\*1 This is the specifications for International model. Please note the specification is different for Japanese domestic mode.

\*2 Please contact us when you need to measure smaller size samples.

### Supplied Software

Output Test Result	Edit Test Condition
<p>The data (Peak Force, OK/NG judgement, Date&amp;Time, Test condition) and statistics can be saved in PC. CSV output and print of result are also possible.</p>	<p>Collectively edit the test condition up to 26 patterns (From A to Z) in PC. The edited conditions are available to be imported to ACT-1000N.</p>

### Operating Environment for the Supplied Software

OS	Windows 8.1/10/11
Hardware	CPU: 1GHz or more
	Memory: 2GB or more
	Hard disk: 10GB (Data storage area) or more
Plat form	.NET Framework 4.6 or later





### Related Products

Jig for round terminals <b>ACT-T-01 *1</b>	Jig for rod terminals <b>ACT-T-02 *1</b>	Jig for ferrule terminal <b>ACT-T-03S/L *1</b>
		<p style="text-align: right;">*2</p>
<p>It is designed easily to fix round terminals. The allowable diameter is <math>\phi 3/5/8</math> mm.</p>	<p>It grips a small terminal such as a rod terminal which has a same diameter as the wire. It can easily chuck the sample with one-touch mechanism.</p>	<p>It consists of a main body and a ferrule terminal fixing plate to hook and fix terminals. The model code varies depending on the hook size of the fixing plate. - ACT-T-03S: Hook size <math>\phi 0.4\text{mm} \sim 2.8\text{mm}</math> - ACT-T-03L: Hook size <math>\phi 3.6\text{mm} \sim 8.0\text{mm}</math></p>
<p>Fixing plate for ferrule terminal <b>ACT-P-03S/L</b></p>	<p>RS232C Printer Package with a Dedicated Cable <b>PRN-SEZD</b></p>	
<p>Plates to fix a wire with the ferrule terminal to the jig, ACT-T-03 series. - ACT-P-03S: Hook size <math>\phi 0.4\text{mm} \sim 2.8\text{mm}</math> - ACT-P-03L: Hook size <math>\phi 3.6\text{mm} \sim 8.0\text{mm}</math></p>	<p>The package of RS232C printer BL2-58 series and RS232C cable CB-208. Measurement data can be printed without PC.</p>	



\*1 Refer to [Dimension] on page 7 for detailed sizes.

\*2 The image is ATC-T-03L.

**Optional attachment ACT-T series usage image (e.g. ACT-T-03L)**

<p>Insert the measuring shaft of ACT-1000N into the main body of ACT-T-03L.</p>	<p>Fix the main body of ACT-T-03L with the snap pin and fixing pin.</p>	<p>Set the sample to the fixing plate of ACT-T-03L and attach it to its main body.</p>	<p>Grip the wire part of the sample with the wire fixture and measure the terminal strength by pulling the wire.</p>
			

**Related Applications**

<p>Simple test by manual tester</p>	<p>Test by motorized test stand</p>	<p>High-capacity wire crimp pull test</p>
		
<p>Configuration DSV-500N / LH-500N</p>	<p>Configuration ZTS-500N / MX2-500N / CB-528 / FW-12 / GP-30</p>	<p>Configuration ZTS-2500N / MX2-2500N / CB-528 / CH-5000N / CW-5000N</p>

**[Dimension]**

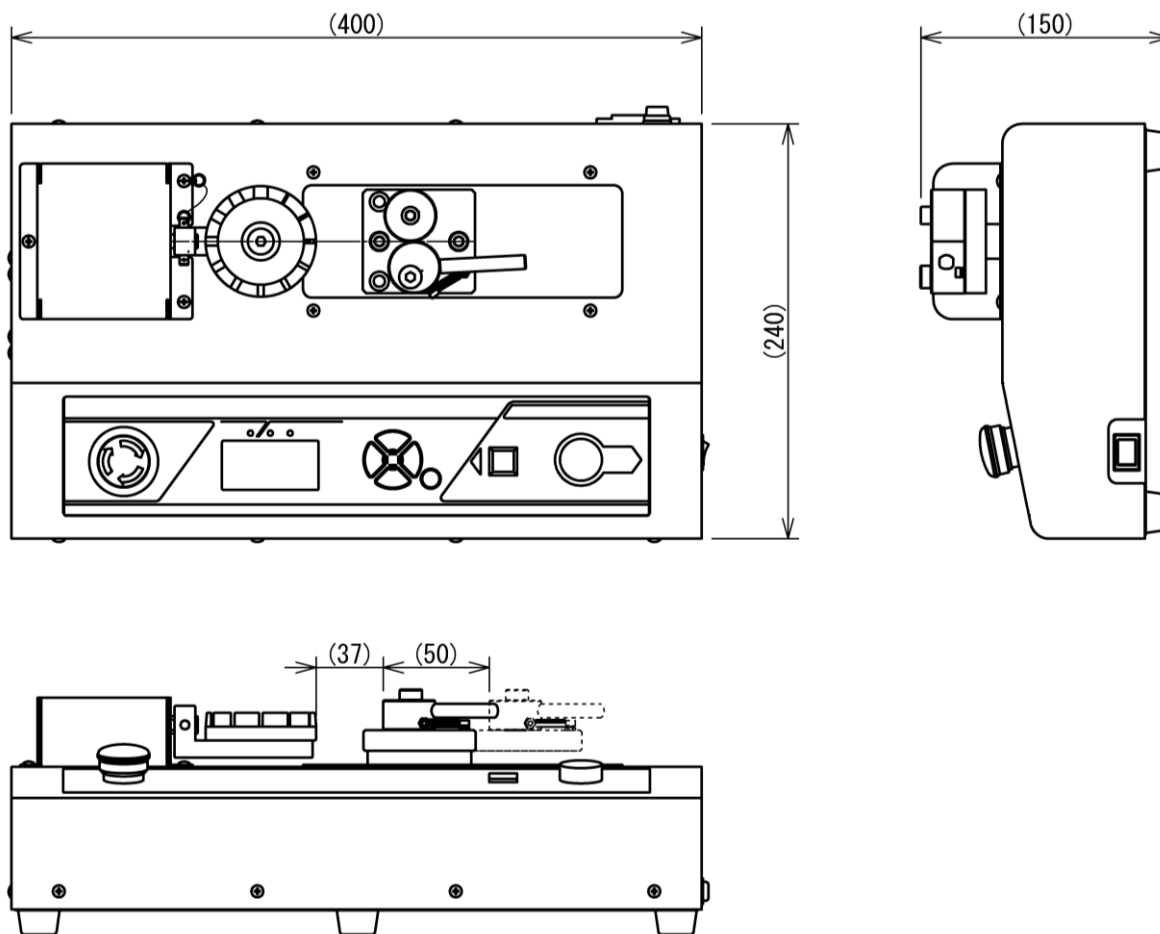

**Wire Terminal Jig (Supplied)**

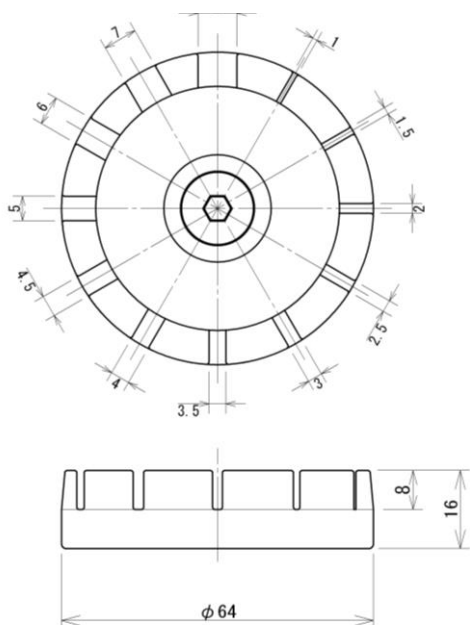

Trench dimensions of Wire Terminal Jig	1, 1.5, 2, 2.5, 3, 3.5, 4, 4.5, 5, 6, 7, 8 (mm)
Allowable diameter of wire clamp jig	1-8 (mm)

Please contact us when you measure smaller size samples.

Jig for round terminals: ACT-T-01 (Option)

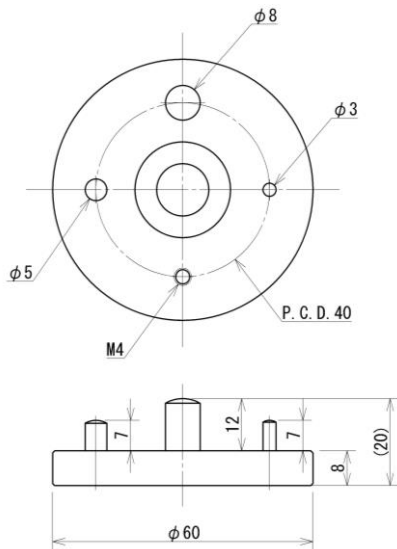

Jig for rod terminals: ACT-T-02 (Option)

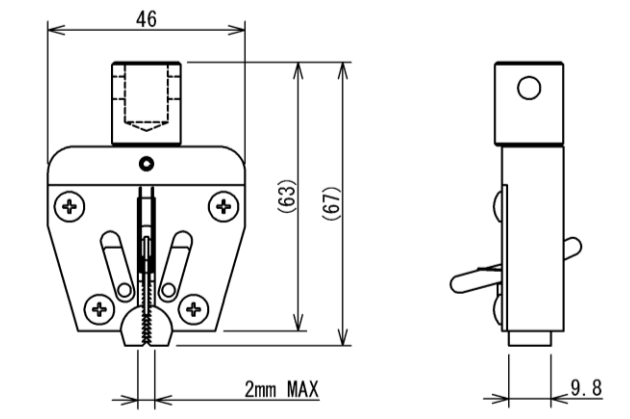

Jig for ferrule terminal: ACT-T-03S/L (Option)

- Main body

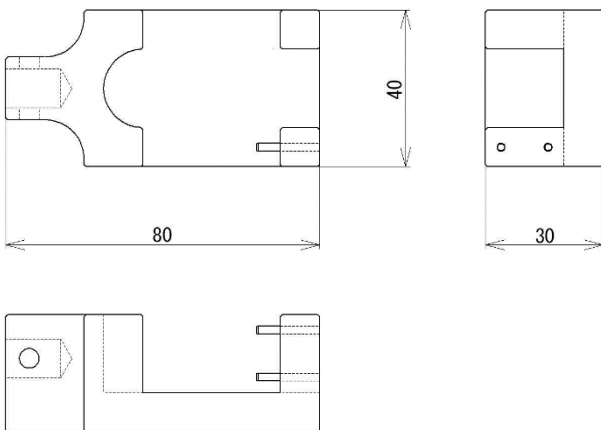

- Included fixing plate of ACT-T-03L (ACT-P-03L)

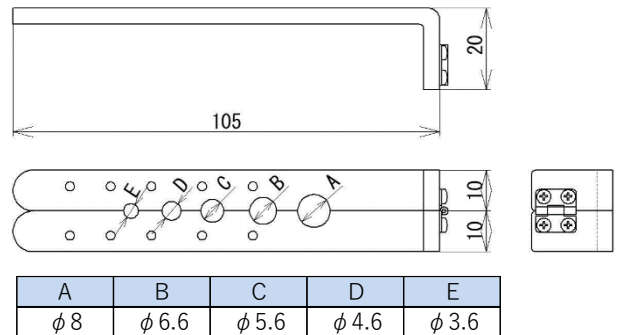

- Included fixing plate of ACT-T-03S (ACT-P-03S)

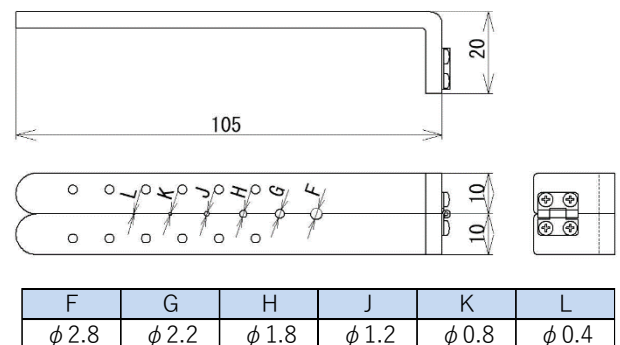

Unit: mm

### [ISO Calibration Service and Calibration Certificate]

- We are the accredited ISO / IEC 17025: 2017 Calibration Organization with the in-house Calibration Service facility.
- The Calibration Service and Issuing of the Calibration Certificates available at cost.
- For further information, please kindly contact the local authorized distributor or us.

### [Cautions]

- Information in this document is subject to change without prior notice.
- This document is product descriptions and handling precautions, and do not guarantee various characteristics or safety.
- This product is designed for force measurement purpose only.
- Do not copy and use this content without authorization.
- Please note that the capacity may be different depending on the displayed unit.
- Do not use this product in the environments including fierce temperature changes, high temperature, high humidity, near water, dusty place.

#### **IMADA CO., LTD.**

99, Jinnoshinden-Cho, Aza, Kanowari, Toyohashi,

Aichi 441-8077, JAPAN

Tel: +81-(0)532-33-3288

Fax: +81-(0)532-33-3866

E-mail: [info@forcegauge.net](mailto:info@forcegauge.net)

Website: <https://www.forcegauge.net/en/>



Visit our website for more information on a wide range of product specifications, measurement applications and videos.