

Pin Grip CP-150N

It is designed to grip wire-shaped samples up to $\phi 3.2\text{mm}$.

It is lightweight & small, fitting for tensile or compression test of lower range in a limited space.



How to Install Test Samples		
Remove Cover, and insert a desired Collet into Body.	Put on the Cover, and insert a test sample into it.	Turn the Cover to fix the test sample.

Specifications	
Model	CP-150N
Capacity	150N
Aperture width	Diameter 0 - 3.2mm
Size	See the "Dimensions"
Weight *1	Approx. 22g (when a collet is combined)
Mounting screw	M6
Accessories	2 pcs of collets (Aperture width [diameter] : 0-1.7mm/1.7-2.3mm/2.3-2.7mm/2.7-3.2mm)

* If your test sample is soft, a gripped part could be broken.



*1 Weight of the attachment is also applied as a load on the force gauge. Consider it when selecting the capacity of a force gauge.

Example of Product Configuration CP-150	
<p>Configuration 1 Code: 1C2002A</p> <p>Simple tensile test up to 150N</p> <p>Digital force gauge: DST-200N Motorized test stand: MX-500N Optional attachment : CP-150N Optional attachment : GT-30(Vice grip)</p>	 <p>Image of Configuration 2</p>
<p>Configuration 2 Code: 1C2002B</p> <p>Tensile test up to 150N with high functionality and versatility.</p> <p>Digital force gauge: ZTS-200N Motorized test stand: MX2-500N Optional attachment: CP-150N Optional attachment: GT-30(Vice grip) Optional cable: CB-528</p>	



* Refer to the specification of each product for details.

* Product configuration varies depending on the shape and characteristic of the sample, and measurement conditions.

* The recommended capacity of force gauge varies depending on the expected force to be loaded.

Mountable Force Gauge for WG-500N and WG-1000N		
DST/DSV series	ZTS/ZTA series	FB/PS/PSM series
Digital force gauge with excellent cost-performance capable to manage data with PC.	Digital force gauge with high precision, featuring high sampling rate and a variety of useful functions.	Mechanical force gauge for easy handling.
		

*Select suitable force gauge to correspond with the mounting screws of attachment.

Related Products		
Jacob's chuck GC-5/GC-15	Wire wrapping grip WG-250N/WG-1000N/WG-5000N	Fine point chuck FP-50/FP-51
- Designed to grip cylindrical-shaped samples - For both tension & compression tests	- Designed for tensile test of strings, wire and the like. - Due to wrapping method, samples get harder to be broken.	- Designed to grip fine strings or threads even at narrow space
		

[Dimensions]

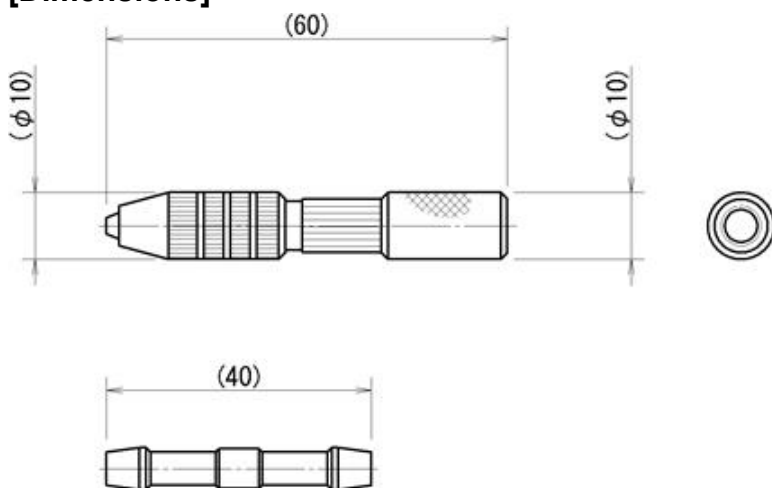

Unit: mm

[Cautions]

- Specifications are subject to change without prior notice.
- A force gauge (sold separately) is required to use this product.
- This product is designed for force testing only. Do not use it for any other purposes.
- Some samples may not be suitable to grip with this product.
- Do not copy and use this content without authorization.

IMADA CO., LTD

99 Jinnoshinden-cho aza Kanowari Toyohashi
 Japan 441-8077
 Tel: +81-(0)532-33-3288
 Fax: +81-(0)532-33-3866
 E-mail: info@forcegauge.net
 Website: <https://www.forcegauge.net/en/>



Visit our website for more information on wide product specifications, measurement applications and videos.