



Hook for Corrugated Cardboard Opening Strength Test DF-60

Designed exclusively for hot-melt adhesive test of corrugated cardboard.
How to measure: Combine the hook with a force gauge, and open the corrugated cardboard using the hook.



Test Method	
Put the hook into the gap.	Pull the force gauge to open the corrugated cardboard.
	

Specifications	
Model	DF-60
Capacity	250N
Hook width	Approx.60mm
Size	Refer to Dimensions.
Weight ※1	Approx.145g
Mounting screw	M6

*1 Weight of the attachment is also applied as a load on the force gauge. Consider it when selecting the capacity of a force gauge.



Examples of Product Configuration	
<p>Configuration 1(*1) Code: 1D2001A</p> <ul style="list-style-type: none"> - Using a mechanical force gauge - Up to 200N <p>Mechanical force gauge: FB-200N Optional attachment: DF-60</p>	 <p>Configuration 2 image</p>
<p>Configuration 2 Code: 1D2001B</p> <ul style="list-style-type: none"> - Using a digital force gauge to achieve greater repeatability (You can manage data on PC.) - Up to 200N <p>Digital force gauge: DSV-200N Optional attachment: DF-60</p>	

*Refer to the specification of each product for details.



*Product configuration varies depending on the shape and characteristic of the sample, and measurement conditions.

*The recommended capacity of force gauge varies depending on the expected force to be loaded.

*1 If you can predict big impact when it is opened, we recommend a digital force gauge rather than a mechanical one since a mechanical force gauge is not suitable for impact test and they cannot acquire peak value accurately.

Mountable Force Gauges		
Digital force gauge DST/DSV series	Digital force gauge ZTS/ZTA series	Mechanical force gauge FB/PS/PSM series
<ul style="list-style-type: none"> - Affordable model - Easy data management on PC 	<ul style="list-style-type: none"> - High sampling speed - High functionality - High precision 	<ul style="list-style-type: none"> - Mechanical - Easy handling
		

*Select suitable force gauge to correspond with the mounting screws of attachment.

Related Products	
PP band tensile testing attachment PPC-5000N	Durability testing fixture PR-500N/PR-2500N
Designed for tensile testing of PP band (Polypropylene band).	Designed for durability test of cardboard.
	

[Dimensions]

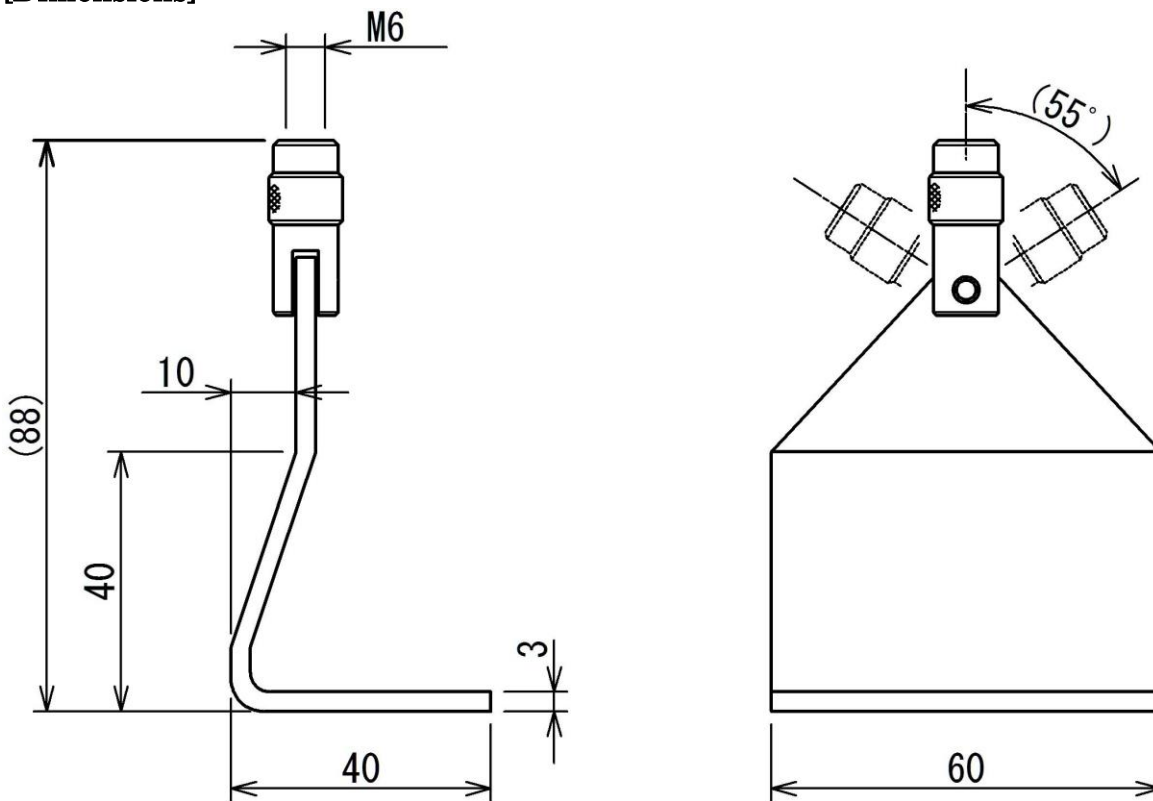

Unit: mm

[Cautions]

- Specifications are subject to change without prior notice.
- A force gauge (sold separately) is required to use this product.
- This product is designed for force testing only. Do not use it for any other purposes.
- Some samples may not be suitable to grip with this product.
- Do not copy and use this content without authorization.

IMADA CO., LTD

99 Jinnoshinden-cho aza Kanowari Toyohashi
 Japan 441-8077
 Tel: +81-(0)532-33-3288
 Fax: +81-(0)532-33-3866
 E-mail: info@forcegauge.net
 Website: <http://www.forcegauge.net/en/>



Visit our website for more information on wide product specifications, measurement applications and videos.