



## Torque Load Cell for eZ-Connect series eHT series

- Suitable for torque measurement (rotating force/twisting force)
- Designed exclusively for eZ-Connect series
- Combine an optional attachment to complete the testing system

eHT series	
  <p>eHT series</p>	 <p>Testing image eHT combined with attachment (HT-DC-6.5)</p>

Easy Installation		
Prepare an attachment.	Insert the attachment to the sensor part.	Use supplied L wrench to fix.
		

\*A wide range of samples can be tested by changing the attachment.

\*We offer custom-made attachment to suit your samples.

\*Attachment is not included in eHT series.





### : eZ-Connect series

eZ-Connect is composed of an amplifier and load cells.



-Allows easy replacement of load cells without additional adjustment

-Suits different types of tests such as tension and torque, measuring from low load to high load etc.

Available load cells have a mark 

Specifications				
Model	eHT-0.5N 	eHT-2N 	eHT-5N 	eHT-10N 
Capacity	0.5N-m (50N-cm)	2N-m	5N-m	10N-m
Accuracy	+/-0.5%F.S. or less			
Safe overload rating	200%			
Working environment (allowable temperature)	-10 to 50degree Celsius (-20 to 60degree Celsius)			
Weight	Approx. 430g			
Cable	Approx. 0.5 to 1m (Curl Cable)			
Dimensions	Refer to [Dimensions]			

\*An amplifier (indicator) is required to read values. Refer to below "Available amplifiers (indicators)" for the detail.

Available Amplifiers (Indicators)		
Type	eZ-Connect series Sensor Interchangeable Amplifier	
Indicator	Desktop type eFA Plus2	Handheld type eZT
Image		
Feature	<ul style="list-style-type: none"> <li>- Desktop use</li> <li>- Load cell interchangeable (such as measurement of tension and torque, or low and high load)</li> </ul>	<ul style="list-style-type: none"> <li>- Handheld use</li> <li>- Load cell interchangeable (such as measurement of tension and torque, or low and high load)</li> </ul>

\* Refer to each indicator specification for the detail.

Specifications of the Sensor and Indicators Combined					
Amplifier	Model	Capacity	Accuracy (*1)	Display	Resolution
eZT or eFA Plus2	eHT-0.5N	50N-cm	+/-0.7% F.S. or less	50.00N-cm	0.01N-cm
	eHT-2N	2N-m (200N-cm)		2.000N-m (200.0N-cm)	0.001N-m (0.1N-cm)
	eHT-5N	5N-m (500N-cm)		5.000N-m (500.0N-cm)	0.001N-m (0.1N-cm)
	eHT-10N	10N-m (1000N-cm)		10.00N-m (1000N-cm)	0.01N-m (1N-cm)

\*1 The accuracy is only available for combinations with the amplifier (indicator).

Cable Options			
	Code *1	Cable Length	Description
Straight Cable	-( )m	Max. 10m	It is an option to change the cable to straight cable which connects to the amplifier (indicator).
Flexible Straight Cable	-BR( )m	Max. 10m	It is an option to change the cable to high flexible cable to reduce the risk of breakage during bending.

\*1 Put Cable Length before "m" of Code. The order increment of the optional cable length is every meter.

\* Curl Cable will be replaced with Straight Cable or Flexible Straight Cable.

\* When ordering cable option, add the code to the end of model.

For example, when ordering eHT-5N with 10m cable length, the product model is "eHT-5N-10m".

**[Related products (Optional Attachment)]** \*Optional attachment is required for measurements using the eHT series.

Pin chuck HT-DC series	Socket holder HT-9.5SQ	M10 Adapter HT-AD-M10
For gripping columnar samples	For various tools such as torque wrench or screw drive bit	For converting to M10 attachment
		
Torque driver (for 0.5N only) HT-DBH-P	Torque driver / 6.35 bit holder HT-DBH	Small table HT-ST
For measuring tightening/loosening torque of No. 00 screw	For measuring tightening/loosening torque	For gripping various sample with switching a pin
		  *Only for 2/5N-m range
Light weight small table HT-STL	Wide table HT-STW	Light weight wide table HT-STLW
Light weight table for 0.5N-m range For small force torque measurement	Wide type of HT-ST for gripping samples from $\phi 10$ to 100mm	Wide type of HT-STL for gripping samples from $\phi 10$ to 100mm
  * Only for 0.5/2N-m range	  *Only for 2/5N-m range	  *Only for 0.5/2N-m range

\* An optional attachment is not included in eHT series.

\* Refer to the specifications of "Attachments for HTGS/HTGA series" for further information.

[Related products]

**Angle Meter Unit: AMK-360**



- Angle meter unit for torque-angle measurement by connecting with handheld digital torque gauge HTGA series
- Angle range: From 0.1 to 9999.9 degree

\* Refer to AMK-360 specification for the detail.

**Integrated Model: HTGS/HTGA Series**



- Integrated model with an indicator and load cell
- Lower price and more precise series for limited use
- A wide range of measurements for various samples by changing a torque attachment (sold separately).

\* Refer to HTGS/HTGA series specification for the detail.

**Graphing Software: Force Recorder**

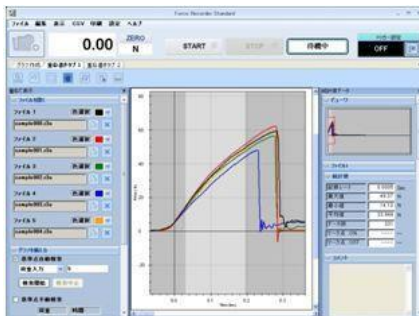

\*The image is Force Recorder Standard.

- Plots graphs of torque-time at real time via USB connection at 2000Hz
- Comment function for keeping a note of testing conditions such as testing speed
- Overlays up to 5 graphs (Standard, Professional edition)
- Analyzes torque-angle relationships. (Professional edition)

\* Refer to each specification for further information.

**Sensor Holder: SHT-5N**



SHT-5N fixes the sensor both horizontally and vertically.



- Designed to hold the handheld type digital torque gauge horizontally or vertically
- Enables high repeatability torque measurement by fixing the sensor
- Attachable to your equipment by screws simply

[Horizontal Sensor Fixing]

- Torque measurement of torsion spring, etc.

[Vertical Sensor Fixing]

- Turning torque of small screws or turbines.
- Simple screw cap measurement ,etc.

\* Cannot be used for 10N-m range.

\* Refer to specification of SHT-5N for further information.

## [Dimension]

### eHT-0.5N/2N/5N

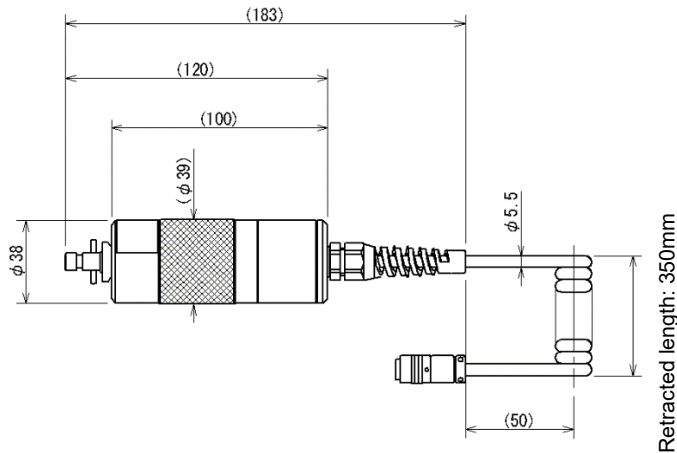

### eHT-10N

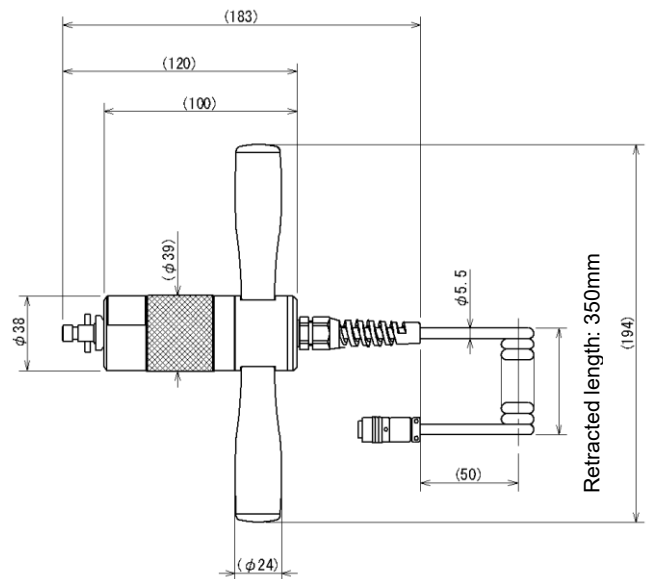

Unit: mm

## [Cautions]

- Information in this document is subject to change without prior notice.
- This document is product descriptions and handling precautions, and do not guarantee various characteristics or safety.
- This product is designed for force measurement purpose only.
- Do not copy and use this content without authorization.
- Do not apply force more than its capacity or from incorrect direction to the measuring shaft.
- Do not use this product in the environments including fierce temperature changes, high temperature, high humidity, near water, dusty place.

### **IMADA CO., LTD**

99 Jinnoshinden-cho aza Kanowari Toyohashi  
Japan 441-8077  
Tel: +81-(0)532-33-3288  
Fax: +81-(0)532-33-3866  
E-mail: [info@forcegauge.net](mailto:info@forcegauge.net)  
Website: <https://www.forcegauge.net/en/>



Visit our website for more information on a wide range of product specifications, measurement applications and videos.