

# Rotary Wire Terminal Fixture FW-12/PW-4

Designed for tensile strength test of crimped terminal  
Rotate the wheel to simply set samples of different sizes

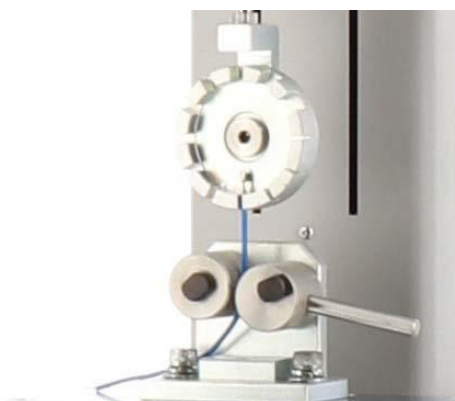

For general terminals: FW-12



Test Image



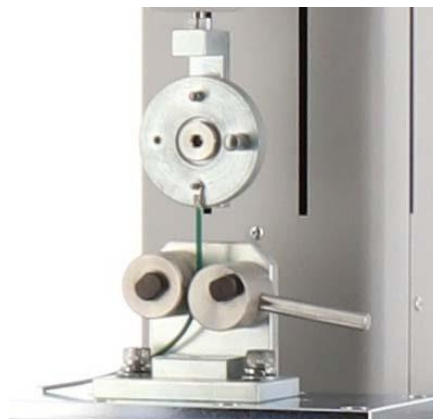

For round terminals: PW-4



Test Image

**Related  
Standard**

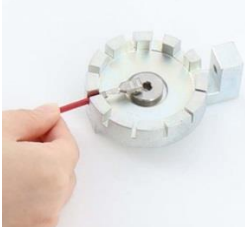
**-IEC 60512-16-4:2008** Connectors for electronic equipment-Tests and measurements-Part 16-4: Mechanical tests on contacts and terminations-Test 16d: Tensile strength (crimped connections)  
(Corresponding Japanese standard: **JIS C5402-16-4:2012**) (When FW-12 is used)  
**-JIS C2805:2010** Crimp-type terminal lugs for copper conductors (Partly)



How to install test sample	
FW-12	PW-4
Insert sample through the fit slit	Hook the round terminal to the pin
	

Specifications		
Model	FW-12	PW-4
Capacity	1000N	1000N
Method of clamp	Hook *1	Hook
Numbers of slits (pins)	12	3
Dimensions of slits (pins)	1 to 8mm	φ3mm/φ5mm/φ8mm/ M4 Female screw*2
Dimensions	See [Dimensions]	
Weight *3	Approx. 380g	Approx. 310g
Mounting screw	M6	M6



\*1 It is not suitable for fixing of narrow terminals such as bar terminals.

\*2 The M4 tapped hole enables you to install desired size of pin to suit your sample.





\*3 Weight of the attachment is also applied as a load on the force gauge. Consider it when selecting the capacity of a force gauge.

Examples of Product Configuration FW-12	
<p><b>Example 1 Code: 1F2001A</b>                      For simple tensile test up to 1000N</p> <p>Digital force gauge: DST-1000N                      Motorized Test Stand: MX-1000N                      Optional Attachment: FW-12                      Optional Attachment: GP-30</p>	 <p>Example 2 Image</p>
<p><b>Example 2 Code: 1F2001B</b>                      Tensile test up to 1000N with high functionality and versatility which complies with <b>IEC 60512-16-4:2008, JIS C5402-16-4:2012</b>, and a part of <b>JIS C2805:2010</b>.</p> <p>Digital force gauge: ZTS-1000N                      Motorized Test Stand: MX2-1000N                      Optional Attachment: FW-12                      Optional Attachment: GP-30                      Optional Cable: CB-528</p>	
Examples of Product Configuration PW-4	
<p><b>Example 1 Code: 1P2002A</b>                      For simple tensile test up to 1000N</p> <p>Digital force gauge: DST-1000N                      Motorized Test Stand: MX-1000N                      Optional Attachment: PW-4                      Optional Attachment: GP-30</p>	 <p>Example 2 Image</p>
<p><b>Example 2 Code: 1P2002B</b>                      Tensile test up to 1000N with high functionality and versatility which complies with a part of <b>JIS C2805:2010</b>.</p> <p>Digital force gauge: ZTS-1000N                      Motorized Test Stand: MX2-1000N                      Optional Attachment: PW-4                      Optional Attachment: GP-30                      Optional Cable: CB-528</p>	

\* Refer to the specification of each product for details.  
 \* Product configuration varies depending on the shape and characteristic of the sample, and measurement conditions.  
 \* The recommended capacity of force gauge varies depending on the expected force to be loaded.

Mountable Force Gauges		
DST/DSV Series	ZTS/ZTA Series	FB/PS/PSM Series
Digital force gauge with excellent cost-performance capable to manage data with PC	Digital force gauge with high precision, featuring high sampling rate and a variety of useful functions	Mechanical force gauge for easy handling
		

\*Select suitable force gauge to correspond with the mounting screws of attachment.

Related Products		
<b>Knurled Cam Grip GP-30</b>	<b>High capacity wire terminal grip CH-5000N</b>	<b>Attachment for loop tensile strength test LOP-1000N</b>
Knurled cam attachment for clamping wire or cable.	Designed for wire terminal test up to 5000N.	Designed for tensile strength test of cable ties up to 1000N.
		
<b>Automatic Crimp Tester ACT-1000N</b>	<b>Crimp tester LH-500N</b>	
Automatic tester for tensile strength test of wire crimped terminal. The supplied software facilitates the management of data and measuring conditions.	Lever operation stand for crimp test. Optional attachments for sample gripping are supplied.	
		

**[Dimensions]**

**FW-12**

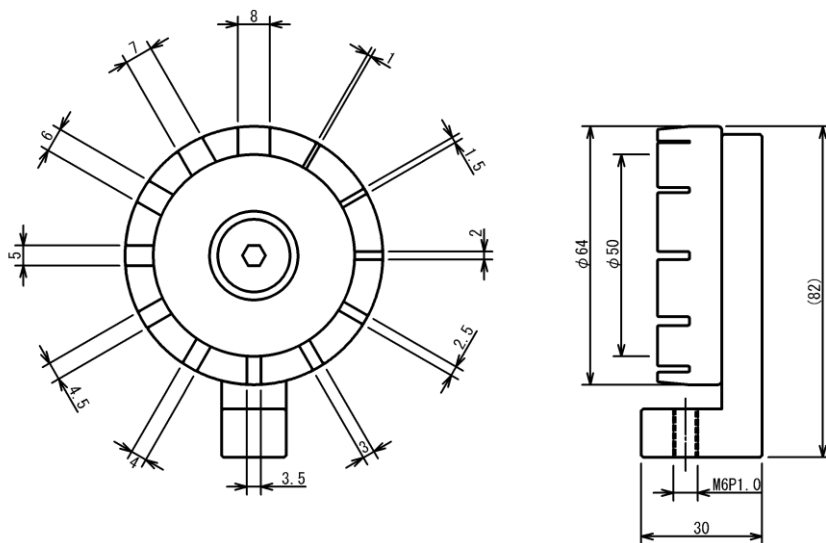

Unit: mm

**PW-4**

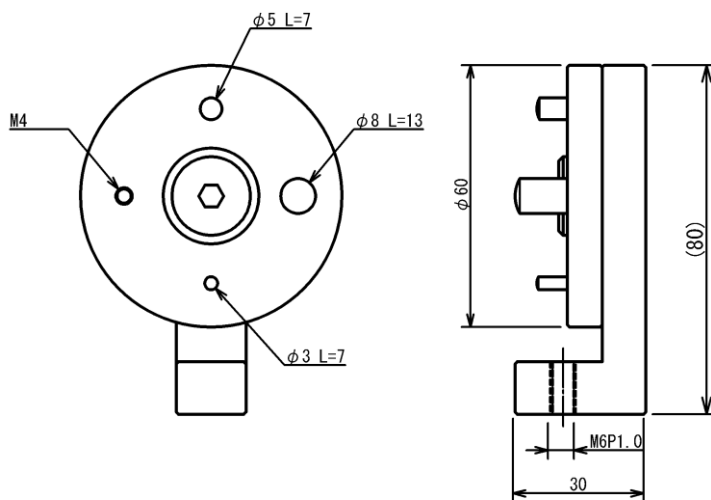

Unit: mm

**[Cautions]**

- Specifications are subject to change without prior notice.
- A force gauge (sold separately) is required to use this product.
- This product is designed for force testing only. Do not use it for any other purposes.
- Some samples may not be suitable to grip with this product.
- Do not copy and use this content without authorization.

**IMADA CO., LTD**

99 Jinnoshinden-cho aza Kanowari Toyohashi  
Japan 441-8077  
Tel: +81-(0)532-33-3288  
Fax: +81-(0)532-33-3866  
E-mail: [info@forcegauge.net](mailto:info@forcegauge.net)  
Website: <https://www.forcegauge.net/en/>



Visit our website for more information on wide product specifications, measurement applications and videos.