

Knurled Cam Grip

GP-15/30

Ideal for tension testing of soft and extensible samples.

Reduces breakage of sample due to cam mechanism.

Designed to set a sample easily and improve measurement efficiency.



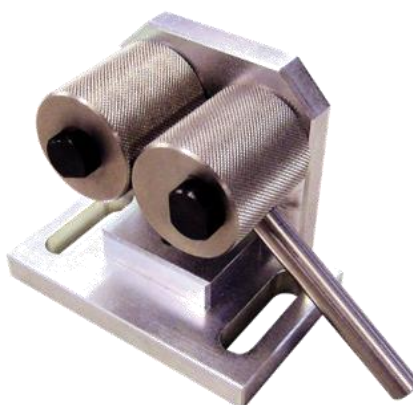

GP-15



GP-30



FW-12/GP-30 Testing Image

Installing for testing		
Lower the lever.	Set the sample.	Raise the lever to clamp.
		



Specification		
Model	GP-15	GP-30
Max. capacity	250N	1000N
Max. sample thickness	4.5mm	10mm
Roller depth	15mm	30mm
Clamp method	Cam clamp *1	
Dimensions	See [Dimensions]	
Weight *2	Approx. 70g	Approx. 880g
Mounting Screw	M6	- *3

* Unsuitable for hard or slippery samples.

*1 Due to the cam clamp mechanism, which influences measurement of displacement in some cases.

*2 Weight of the attachment is also applied as a load on the force gauge. Consider it when selecting the capacity of a force gauge.

*3 GP-30 cannot be attached to force gauge. Please mount it to the test stand.







Example of Product Configuration GP-15	
<p>Example1 Code:1G2011A For simple handheld tension strength test up to 250N</p> <p>Digital force gauge: DST-500N Manual test stand: HV-1000N Option attachment: GP-15 (2pcs)</p>	
<p>Example2 Code:1G2011B For functional and versatile tension strength test up to 250N</p> <p>Digital force gauge: ZTS-500N Motorized test stand: MX2-500N Option attachment: GP-15 (2pcs) Option cable: CB-528</p>	
Example of Product Configuration GP-30	
<p>Example1 Code : 1F2001B Tension test up to 1000N with high functionality and versatility. Complies with IEC 60512-16-4:2008, JIS C5402-16-4:2012, and a part of JIS C2805:2010.</p> <p>Digital force gauge: ZTS-1000N Motorized test stand: MX2-1000N Option attachment: GP-30 Option attachment: FW-12 Option cable: CB-528</p>	
	GP-30 Example1 Image

* Please refer to specifications of the individual products for details.



* Product configuration depends on shape and characteristic of samples and measurement condition.

* The recommended capacity of force gauge varies depending on the expected force to be loaded.

* Extensible samples require longer stroke. Therefore, you need to select a test stand which has long stroke enough for the sample.

Related Products		
Cam Grip GR-30/2000	Roller Grip GC-60/100	Rotary Wire Terminal Fixture FW-12
Ideal for gripping thin and rectangle shaped samples.	Ideal for testing elastic or deformable samples. This grip holds a sample tightly.	Designed for tension strength test of crimped terminal. Easy sample set up for different sizes.
		
Rotary Wire Terminal Fixture PW-4	Automatic Crimp Tester ACT-1000N	Crimp Tester LH-500N
Designed for tension strength test of crimped terminal. Easy sample set up for different sizes.	Automatic tester for tensile strength test of wire crimped terminal. The supplied software facilitates the management of data and measuring conditions.	Lever operation stand for crimp test. Optional attachments for sample gripping are supplied.
		

* Please refer to specifications of the individual products for details.

Mountable Force Gauge		
DST/DSV series	ZTS/ZTA series	FB/PS/PSM series
Simple-to-use basic Digital force gauge with adequate performance and data management possible with PC.	High precision Digital Force gauge, with a high sampling rate and useful functions.	Easy handling Mechanical force gauge.
		

* Please refer to specifications of the individual products for details.

* Suitable selection of the Attachment mounting screws for the Force-gauge needs to be confirmed.

[Dimensions]

GP-15

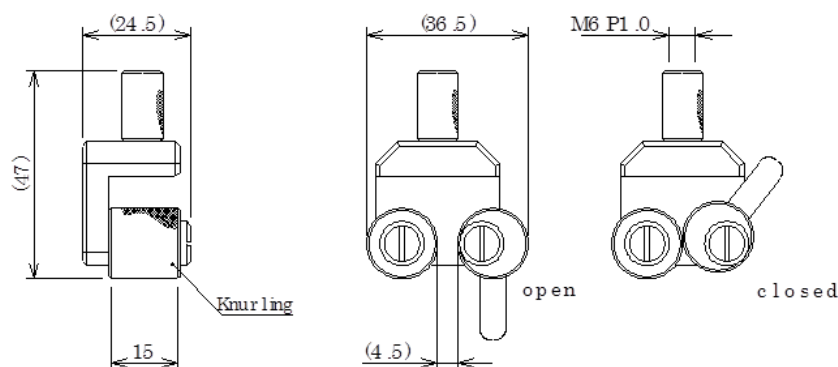

GP-30

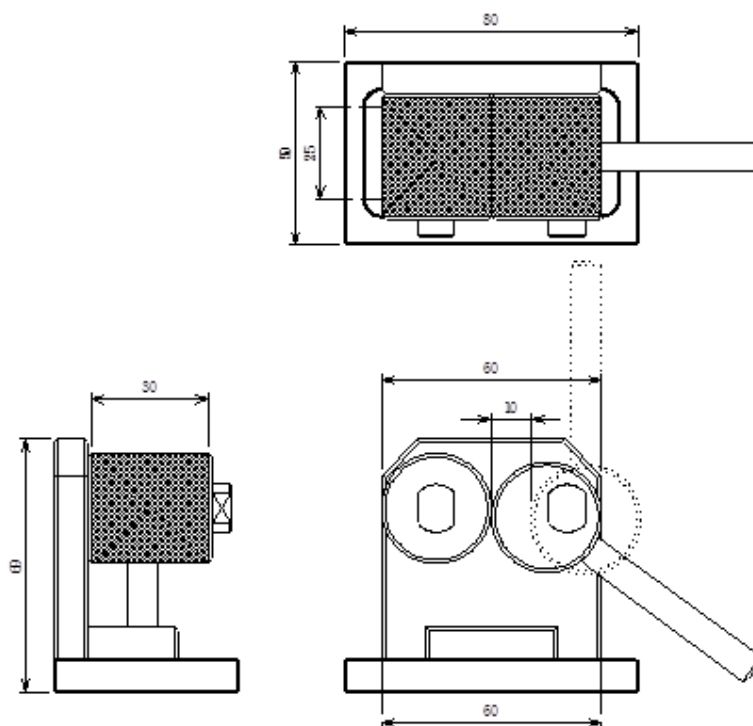

Unit: mm

[Cautions]

- Information in this document is subject to change without prior notice.
- This document is product descriptions and handling precautions, and do not guarantee various characteristics or safety.
- This product is designed for force measurement purpose only.
- Do not copy and use this content without authorization.
- A force gauge (sold separately) is required to use this product.
- Some samples may not be suitable to measure with this product.

IMADA CO., LTD.

99, Jinnoshinden-Cho, Aza, Kanowari, Toyohashi,
Aichi 441-8077, JAPAN
Tel: +81-(0)532-33-3288
Fax: +81-(0)532-33-3866
E-mail: info@forcegauge.net
Website: <https://www.forcegauge.net/en/>



Visit our website for more information on a wide range of product specifications, measurement applications and videos.