

## Attachments for HTGS/HTGA series HT series

- Enables to select from various attachments to suit measurement samples
- Combine with HTGS/HTGA series (separately sold) for various torque measurement, such as operational torque of rotary switches and tighten torque of screws.

A wide range of attachments are available to support various measurements.



Small Table



Light Weight Wide Table



Pin Chuck



Socket holder



Torque driver



M10 Adapter

The same attachments can be fixed to the eHT series, SDT series, and RSH series to measure torque.

Compatible products		
HTGS/HTGA series, eHT series	SDT series	RSH series

■ **Small Table**

Small Table Standard Pin <b>HT-ST</b>	Small Table Notch Pin <b>HT-ST-01 (*1)</b>	Small Table Long Clamp Pin <b>HT-ST-02 (*1)</b>
		
Suitable for measuring small samples such as eye drop lids.	Ideal for firmly fixing samples such as connectors made of resin.	Ideal for fixing slim samples such as cosmetic containers.
<ul style="list-style-type: none"> <li>• Small Table Capacity: 5N-m Allowable Sample Diameter: <math>\phi 7</math> to 50mm Weight: Approx.300g Material: Steel and Aluminum</li> <li>• Standard Pin Pin weight: Approx.3g/pcs Pin material: Aluminum and Urethan</li> </ul>	<ul style="list-style-type: none"> <li>• Small Table Capacity: 5N-m Allowable Sample Diameter: <math>\phi 7</math> to 50mm Weight: Approx.300g Material: Steel and Aluminum</li> <li>• Notch Pin Pin weight: Approx.10g/pcs Pin material: Stainless-steel</li> </ul>	<ul style="list-style-type: none"> <li>• Small Table Capacity: 5N-m Allowable Sample Diameter: <math>\phi 7</math> to 50mm Weight: Approx.300g Material: Steel and Aluminum</li> <li>• Long Clamp Pin Pin weight: Approx.8g/pcs Pin material: Aluminum and Urethan</li> </ul>

\* Small table and pins cannot be used for torque gauges with capacity of 0.5N-m.



\*1 Standard Pins shown on the Small Table pictures are for the image reference. Instead, 4pcs of each pin option in the image above are included.

■ **Light Weight Small Table (For 0.5/2N-m range)**

Light Weight Small Table Standard Pin <b>HT-STL</b>	Light Weight Small Table Notch Pin <b>HT-STL-01 (*1)</b>	Light Weight Small Table Long Clamp Pin <b>HT-STL-02 (*1)</b>
		
Suitable for measuring small samples such as plastic tubes.	Ideal for firmly fixing samples such as small motors.	Ideal for fixing slim samples such as cosmetic containers.
<ul style="list-style-type: none"> <li>• Light Weight Small Table Capacity: 2N-m Allowable Sample Diameter: <math>\phi 7</math> to 50mm Weight: Approx.150g Material: Aluminum</li> <li>• Standard Pin Pin weight: Approx.3g/pcs Pin material: Aluminum and Urethan</li> </ul>	<ul style="list-style-type: none"> <li>• Light Weight Small Table Capacity: 2N-m Allowable Sample Diameter: <math>\phi 7</math> to 50mm Weight: Approx.150g Material: Aluminum</li> <li>• Notch Pin Pin weight: Approx.10g/pcs Pin material: Stainless-steel</li> </ul>	<ul style="list-style-type: none"> <li>• Light Weight Small Table Capacity: 2N-m Allowable Sample Diameter: <math>\phi 7</math> to 50mm Weight: Approx.150g Material: Aluminum</li> <li>• Long Clamp Pin Pin weight: Approx.8g/pcs Pin material: Aluminum and Urethan</li> </ul>

\*1 Standard Pins shown on the Light Weight Small Table pictures are for the image reference. Instead, 4pcs of each pin option in the image above are included.



■ **Wide Table**

Wide Table Standard Pin <b>HT-STW</b>	Wide Table Notch Pin <b>HT-STW-01 (*1)</b>	Wide Table Long Clamp Pin <b>HT-STW-02 (*1)</b>
		
<p>Suitable for measuring samples such as car air conditioning dials.</p>	<p>Ideal for firmly fixing wide samples such as tablet bottles.</p>	<p>Ideal for fixing long and wide samples such as faucets or stop cocks.</p>
<ul style="list-style-type: none"> <li>• Wide Table Capacity: 5N-m Allowable Sample Diameter: φ10 to 100mm Weight: Approx.340g Material: Steel and Aluminum</li> <li>• Standard Pin Pin weight: Approx.3g/pcs Pin material: Aluminum and Urethan</li> </ul>	<ul style="list-style-type: none"> <li>• Small Table Capacity: 5N-m Allowable Sample Diameter: φ10 to 100mm Weight: Approx.340g Material: Steel and Aluminum</li> <li>• Notch Pin Pin weight: Approx.10g/pcs Pin material: Stainless-steel</li> </ul>	<ul style="list-style-type: none"> <li>• Small Table Capacity: 5N-m Allowable Sample Diameter: φ10 to 100mm Weight: Approx.340g Material: Steel and Aluminum</li> <li>• Long Clamp Pin Pin weight: Approx.8g/pcs Pin material: Aluminum and Urethan</li> </ul>



\* Wide table and pins cannot be used for torque gauges with capacity of 0.5N-m.

\*1 Standard Pins shown on the Wide Table pictures are for the image reference. Instead, 4pcs of each pin option in the image above are included.



■ **Light Weight Wide Small Table**

Light Weight Wide Table Standard Pin <b>HT-STLW</b>	Light Weight Wide Table Notch Pin <b>HT-STLW-01 (*1)</b>	Light Weight Wide Table Long Clamp Pin <b>HT-STLW-02 (*1)</b>
		
<p>Suitable for measuring samples such as volume dials.</p>	<p>Ideal for firmly fixing samples such as motors.</p>	<p>Ideal for fixing long and wide samples such as bottle shaped containers and diapers.</p>
<ul style="list-style-type: none"> <li>• Light Weight Wide Table Capacity: 2N-m Allowable Sample Diameter: φ10 to 100mm Weight: Approx.200g Material: Aluminum</li> <li>• Standard Pin Pin weight: Approx.3g/pcs Pin material: Aluminum and Urethan</li> </ul>	<ul style="list-style-type: none"> <li>• Light Weight Wide Table Capacity: 2N-m Allowable Sample Diameter: φ10 to 100mm Weight: Approx.200g Material: Aluminum</li> <li>• Notch Pin Pin weight: Approx.10g/pcs Pin material: Stainless-steel</li> </ul>	<ul style="list-style-type: none"> <li>• Light Weight Wide Table Capacity: 2N-m Allowable Sample Diameter: φ10 to 100mm Weight: Approx.200g Material: Aluminum</li> <li>• Long Clamp Pin Pin weight: Approx.8g/pcs Pin material: Aluminum and Urethan</li> </ul>

\*1 Standard Pins shown on the Light Weight Wide Table pictures are for the image reference. Instead, 4pcs of each pin option in the image above are included.

Test image		
		
<p>Step 1: Screw the pins.</p>	<p>Step 2: Fix the sample.</p>	<p>Step 3: Turn the sample to measure torque.</p>

**[Pins]** The set of Pins are available for replacement for purchase separately.

Standard Pin <b>ST-P</b>	Notch Pin <b>ST-01P</b>	Long Clamp Pin <b>ST-02P</b>
		
<p>Urethane made pins. It is ideal for gripping plastic made samples such as bottle caps.</p>	<p>Stainless made pins. It is ideal for gripping samples such as resin made connectors.</p>	<p>Urethane made pins. It is ideal for fixing slim samples such as cosmetic containers.</p>

\* Each Pins are sold in set of 4.

**[Dimensions]**

**HT-ST**

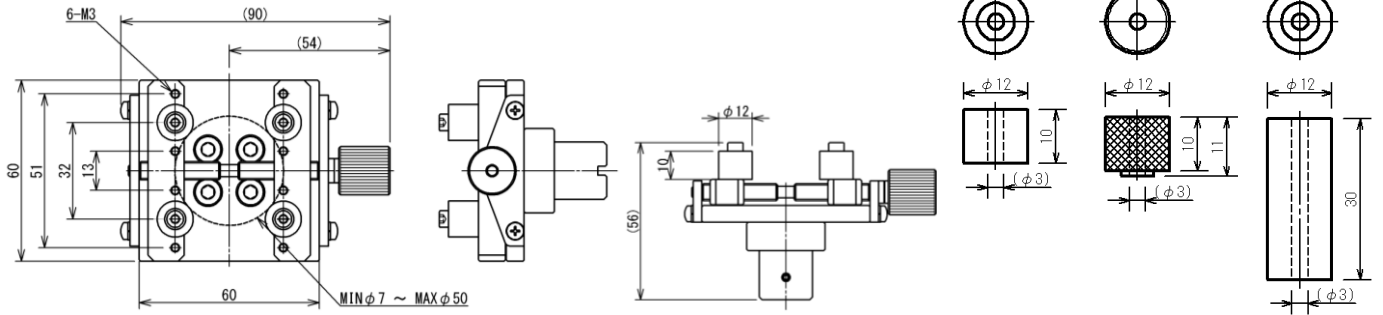

**HT-STL**

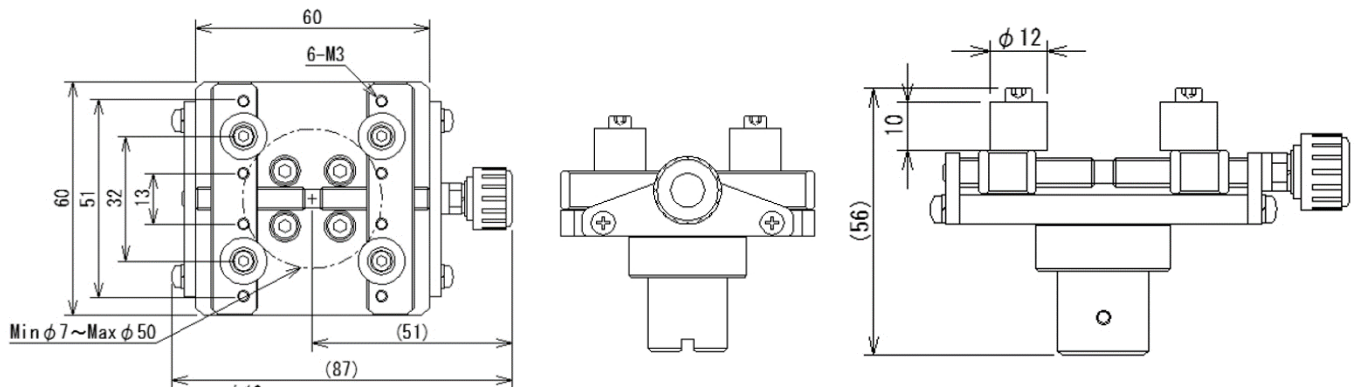

**HT-STW/HT-STLW**

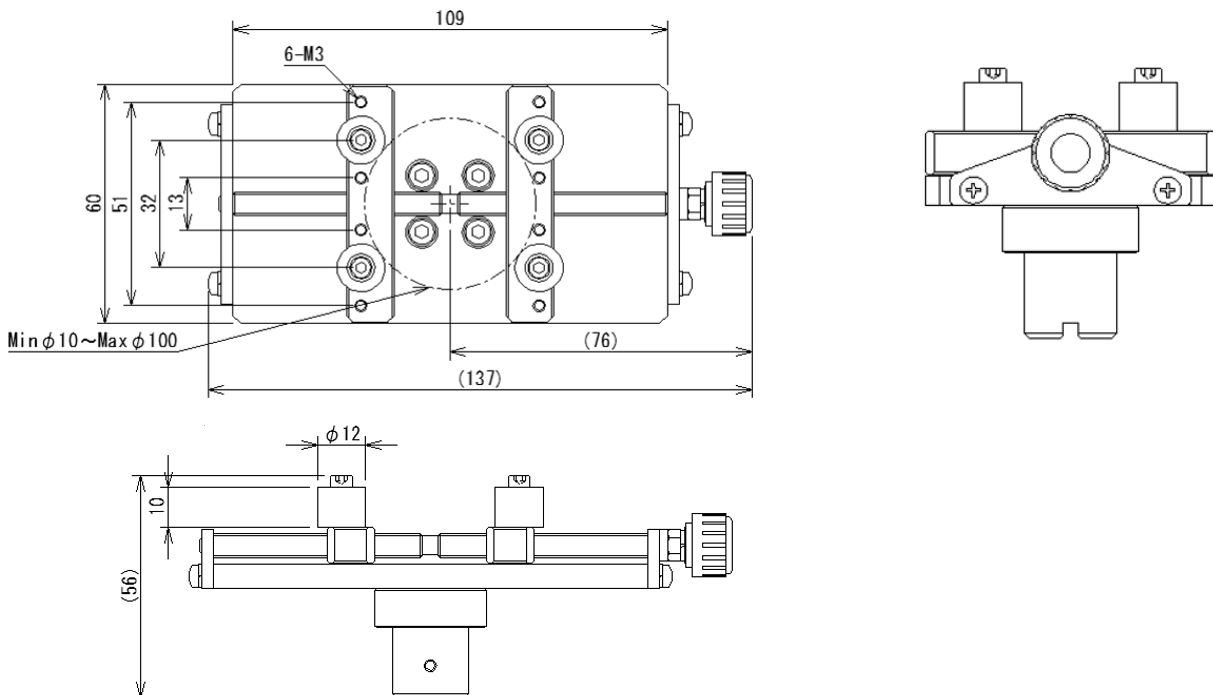

Unit : mm

■ Pin Chuck

	Feature
	The three claws clamp samples such as wire and round-bar samples.



[Specifications]

Model	HT-DC-4	HT-DC-6.5 (*1)	HT-DC-6.5SUS (*1)	HT-DC-13 (*2)
Capacity	5N-m	10N-m	10N-m	10N-m
Opening width	φ0.5~4mm	φ0.5~6.5mm	φ0.5~6.5mm	φ1.2~13mm
Weight	Approx.100g	Approx.200g	Approx.190g	Approx.600g
Material	Steel	Steel	Stainless-steel (*3)	Steel

\*1 HT-DC-6.5 and HT-DC-6.5SUS cannot be used for torque gauges with capacity of 0.5N-m.

\*2 HT-DC-13 cannot be used for torque gauges with capacity of 2N-m.

\*3 We recommend using the stainless-steel chuck under the circumstance making metal rust.

Test image		
 <p>Step1: Mount the pin chuck on the torque sensor.</p>	 <p>Step 2: Hold the sample. Turn the sleeve and tighten the sample with the included chuck key.</p>	 <p>Step 3: Twist the holding sample and measure the torque.</p>

[Dimensions]

HT-DC-4

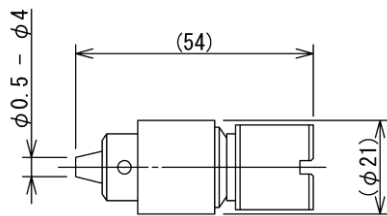

HT-DC-6.5/ DT-DC-6.5SUS

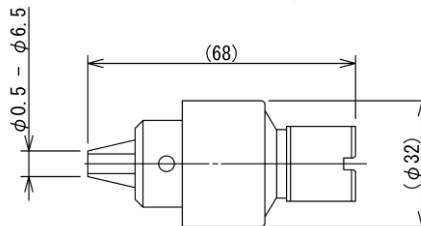

HT-DC-13

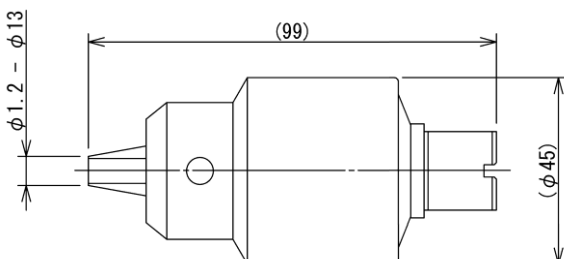

Unit: mm

■ Socket holder

	Feature
	Enables to measure torque by connecting a tool such as a driver bits and wrenches etc.

[Specifications]



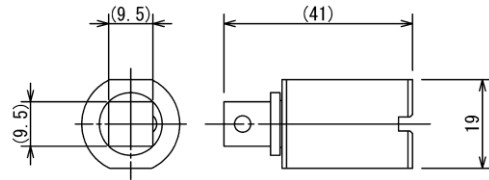

Model	HT-9.5SQ
Socket	9.5mm square
Weight	Approx.100g

\* Socket holder cannot be used for torque gauges with capacity of 0.5N-m.

[Dimensions]



Unit: mm

Test image			
 <p>Step 1: Prepare a 9.5mm square socket wrench.</p>	 <p>Step 2: Mount the socket wrench on the socket holder.</p>	 <p>Step 3: Mount the Step 2 socket holder on the torque sensor.</p>	 <p>Step 4: Twist a bolt with the socket wrench and measure the torque.</p>

Torque driver

	Feature
	Measure tighten and loosen screw torque with the included screwdriver bit. 6.35mm bit can be installed. (Only for HT-DBH)

[Specifications]

Model	HT-DBH *1	HT-DBH-P *2
Bit	⊕1⊕2⊕3x⊖6x45mm	⊕00x50mm
Weight	Approx.100g	Approx.12g

\* Bits other than VESSEL branded may not fit to the holder.

\*1 HT-DBH cannot be used for torque gauges with capacity of 0.5N-m.

\*2 HT-DBH-P is only for torque gauges with capacity of 0.5N-m.

[Dimensions]

HT-DBH

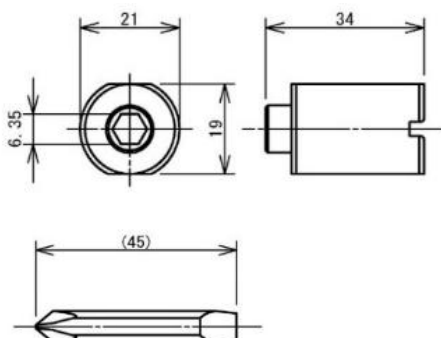

HT-DBH-P

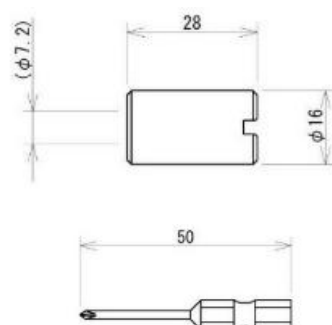

Unit: mm

### M10 adapter

	Feature
	<p>The Adapter for adjusting the Thread-size to M10.          To be used with the M10 Thread-size attachments.</p>

### [Specifications]

Model	HT-AD-M10
Screw	M10×L20
Weight	Approx.50g

### [Dimensions]

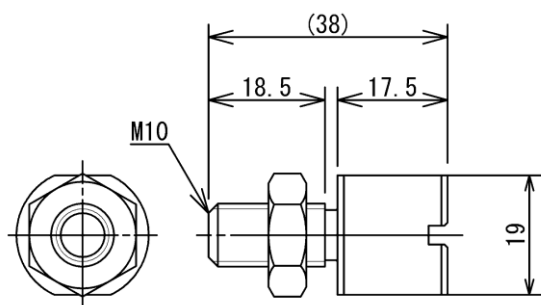

Unit: mm

### [Cautions]

- Information in this document is subject to change without prior notice.
- This document is product descriptions and handling precautions, and do not guarantee various characteristics or safety.
- This product is designed for force measurement purpose only.
- Do not copy and use this content without authorization.
- Some samples may not be suitable to measure with this product.

#### **IMADA CO., LTD**

99 Jinnoshinden-cho aza Kanowari Toyohashi  
 Aichi Japan 441-8077  
 Tel: +81-(0)532-33-3288  
 Fax: +81-(0)532-33-3866  
 E-mail: [info@forcegauge.net](mailto:info@forcegauge.net)  
 Website: <https://www.forcegauge.net/en/>



Visit our website for more information on a wide range of product specifications, measurement applications and videos.