

Fixtures set for shear test LF

Designed to measure tensile strength and shear strength of solder joint

Easy to adjust tiny positioning with XY stage

Complies with the corresponding part of JIS standard

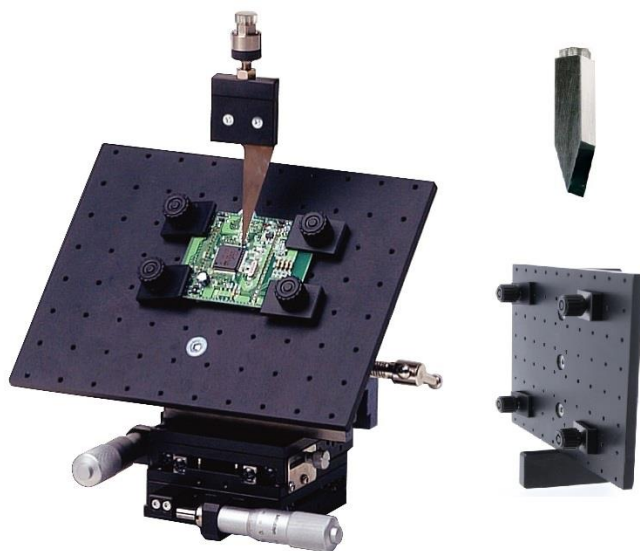

LF

(Not included electronic circuit)

Fixtures set for shear test of QFP lead and chip components

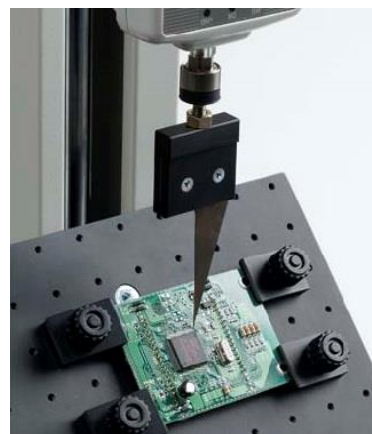



LF(QFP45-100N) Test Image





LF(TIP90-100N) Test image

**Related
Standard**

- JIS Z 3198-6 : 2003 Test methods for lead-free solders Part 6: Methods for 45-degree pull test of solder joints on QFP lead (corresponding part only)
- JIS Z 3198-7 : 2003 Test methods for lead-free solders Part 7: Methods for shear strength of solder joints on chip components (corresponding part only)





How to Install Test sample (QFP45-100N)		
Fix sample to 45-degree table	Adjust position of hook tip with XY stage	Hook the soldered part to start testing
		

How to Install Test sample (TIP90-100N)		
Fix sample to 90-degree table	Adjust position of jig tip by XY stage	Push the soldered part with jig to start testing
		

Specifications	
Model	LF
Capacity	100N
Dimensions	See [Dimensions]
Mounting Screws	M6
Weight (*1)	QFP lead hook: approx.60g Chip shear jig: approx.50g XY table: approx.650g XY stage: approx.2600g
XY stroke	±12.5mm (resolution 0.01mm)
Components	QFP lead hook: QFP45-1 Chip shear jig: TIP90-1 45-degree table: QFP45-2 90-degree table: TIP90-2 XY stage: QFP-1
Related Standard	JIS Z 3198-6 : 2003 JIS Z 3198-7 : 2003

*1 Weight of the attachment is also applied as a load on the force gauge. Consider it when selecting the capacity of a force gauge.

Fixtures set and separated item are available to meet your needs.

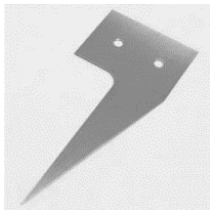

LF	QFP45-100N	TIP90-100N
A set for 45-degree pull test of QFP lead and shear strength of chip components	A set for 45-degree pull test of QFP lead	A set for shear test of chip components
Contents:1. QFP45-1 2. QFP45-2 3. TIP90-1 4. TIP90-2 5. QFP-1	Contents:1. QFP45-1 2. QFP45-2 5. QFP-1	Contents:3. TIP90-1 4. TIP90-2 5. QFP-1
1.QFP45-1	2.QFP45-2	3.TIP90-1
45-degree lead hook	45-degree table	90-degree chip shear jig
		
4.TIP90-2	5.QFP-1	
90-degree table	XY stage	
		

[Spare blade] Spare blade is available.





QFP45-SB-1
Spare blade for QFP lead hook QFP45-1

Examples of Product Configuration LF	
<p>Example 1 Code : 1L20001</p> <p>- Shear test up to 1000N according to JIS Z 3198-6:2003 or JIS Z 3198-7:2003</p> <p>Digital force gauge : ZTS-100N Motorized Test Stand : MX2-500N-L Optional Motorized Test Stand : -V90 Optional Attachment : LF Optional Cable : CB-518</p>	 Example1 Image

- * Refer to the specification of each product for details.
- * Product configuration varies depending on the shape and characteristic of the sample, and measurement conditions.
- * The recommended capacity of force gauge varies depending on the expected force to be loaded.

Mountable Force Gauges		
DST/DS Series	ZTS/ZTA Series	FB/PS/PSM Series
Digital force gauge with excellent cost-performance capable to manage data with PC	Digital force gauge with high precision, featuring high sampling rate and a variety of useful functions	Mechanical force gauge for easy handling
		

* Select suitable force gauge to correspond with the mounting screws of attachment.

Related Products		
Chip shear jig GT-10/20	Small Grips SC-3/8	Pantograph Grips PGC-0505/0510/2530
Ideal for shear test of electric components	Ideal for measuring of small diameter test pieces in a small area	Ideal for tensile test, gripping various type of samples
		
180-degree Peeling Tester IPTS-5N		
Specialized for peel test of embossed carrier tape easily and precisely		
		

[Dimensions]

QFP45-100N

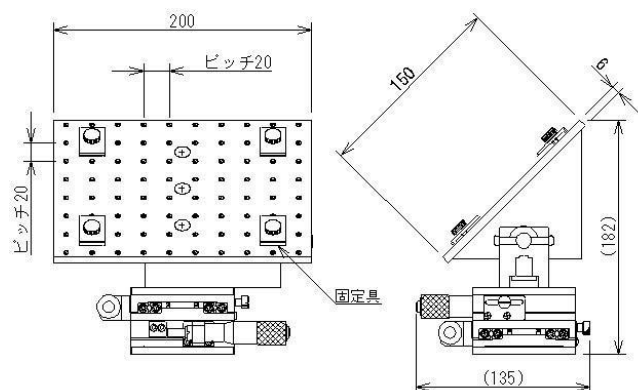

XY table for 45-degree pull test

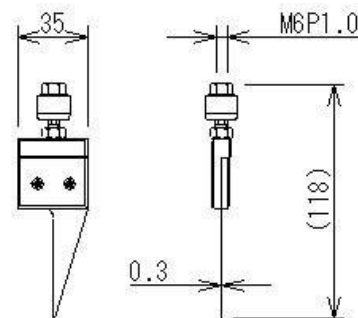

QFP lead hook

TIP90-100N

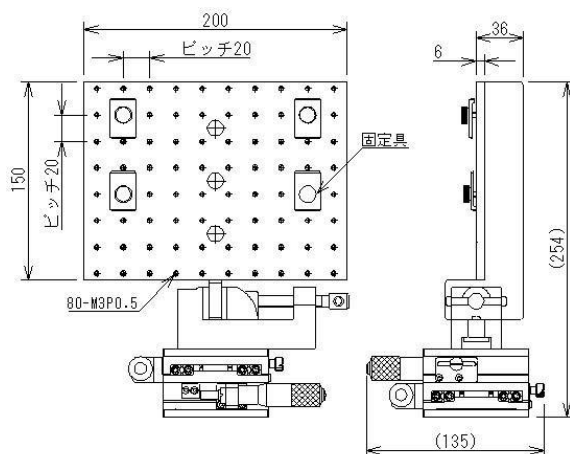

XY table for 90-degree shear test

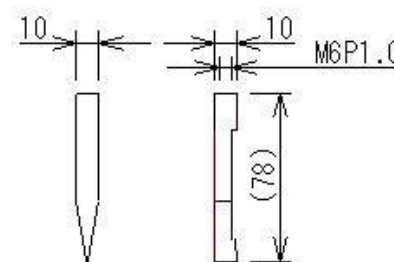

Shear jig

Unit : mm

[Cautions]

- The contents may be changed without previous notice.
- A force gauge (sold separately) is required to use this product.
- This product is designed for force testing only. Do not use it for any other purposes.
- Some samples may not be suitable to measure.
- Do not copy and use this content without authority.

IMADA CO., LTD

99 Jinnoshinden-cho aza Kanowari Toyohashi
 Japan 441-8077
 TEL: +81-(0)532-33-3288
 FAX: +81-(0)532-33-3866
 E-mail: info@forcegauge.net
 Website: <http://www.forcegauge.net/en/>



Visit our website for more information on wide products specifications, measurement applications and videos.