

Attachments for ACMTS/MTS series MT series

Attachments for IMADA torque stand ACMTS series and MTS series
Various attachments are available to suit your samples

<Attachment selections usable for samples of different sizes, shapes and materials>



Standard Chuck



Small Chuck



Pin Chuck





M10 Adapter

■ Standard Chuck

Standard Chuck and Standard Pin	
MT-TB	
	<p>Suitable for clamping samples such as bottle caps.</p> <ul style="list-style-type: none"> • Standard Chuck Capacity: 5N-m Allowable Sample Diameter: $\phi 20$ to 90mm Weight: Approx.700g Material: Steel • Standard Pin Pin weight: Approx.22g/pcs Pin material: Aluminum and Urethan

[Pins and Spare Rubbers] Pins and Spare Rubbers are available for replacement.

Standard Pin MT-TB-P	Long Shaft Pin MT-TB-03P	Spare Rubber MT-TB-RB
		
<p>Suitable for clamping samples such as bottle caps</p> <p>Pin weight: Approx.22g/pcs Pin material: Aluminum and Urethan</p>	<p>Suitable for holding nozzle caps, etc. since its long shaft allows the pin knob to avoid obstacles and to clump the sample properly.</p> <p>Pin weight: Approx.48g/pcs Pin material: Steel, Aluminum, and Urethan</p>	<p>Spare replacement rubber for MT-TB Pins.</p> <p>Compatible model: MT-TB-P / MT-TB-03P</p>

* For the purchase of Standard Chuck with Long Shaft Pins, please contact us.

* Pins and Spare rubbers are sold in set of 4.

Tips for Appropriate Measurement

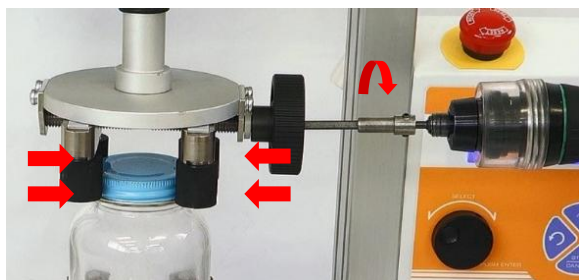

Enables high repeatability torque measurement by constantly fastening with torque measuring instrument.

* For Samples with slippery surface, custom-made attachments are available to meet the measurement requirements at your request.

[Dimensions]

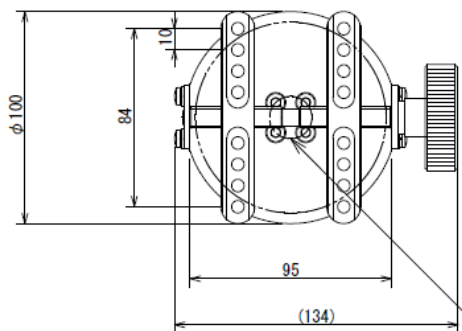

Allowable sample diameter $\phi 20 \sim \phi 90$

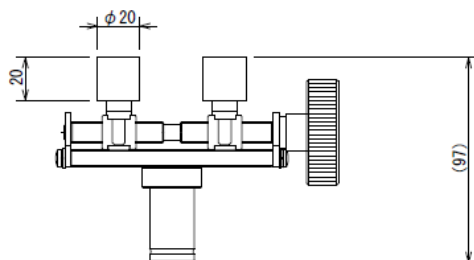
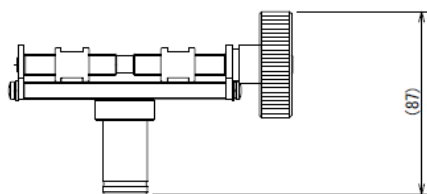
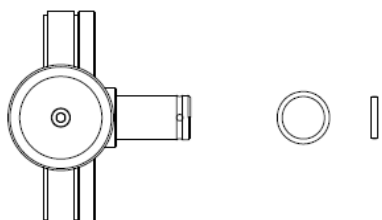

The dimension at mounting the pins

Pins

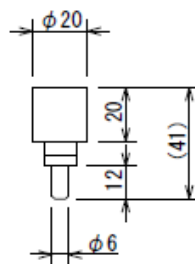

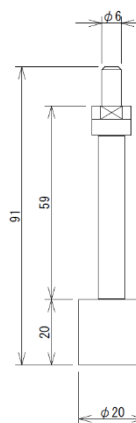

MT-TB-P



MT-TB-03P



Unit: mm

■ **Small Chuck**

Small Chuck Standard Pin MT-ST	Small Chuck Notch Pin MT-ST-01	Small Chuck Long Clamp Pin MT-ST-02
		
<p>Suitable for measuring small samples such as eye drop lids.</p>	<p>Suitable for firmly fixing samples such as connectors made of resin.</p>	<p>Suitable for clamping samples such as nozzle caps.</p>
<ul style="list-style-type: none"> • Small Chuck Capacity: 5N-m Allowable Sample Diameter: φ7 to 50mm Weight: Approx.270g Material: Steel and Urethan • Standard Pin Pin weight: Approx.3g/pcs Pin material: Aluminum and Urethan 	<ul style="list-style-type: none"> • Small Chuck Capacity: 5N-m Allowable Sample Diameter: φ7 to 50mm Weight: Approx.270g Material: Steel and Urethan • Standard Pin Pin weight: Approx.10g/pcs Pin material: Stainless-steel 	<ul style="list-style-type: none"> • Small Chuck Capacity: 5N-m Allowable Sample Diameter: φ7 to 50mm Weight: Approx.270g Material: Steel and Urethan • Standard Pin Pin weight: Approx.8g/pcs Pin material: Aluminum and Urethan

* For Samples with slippery surface, custom-made attachments are available to meet the measurement requirements at your request.

[Pins] Pins are available for replacement.

Standard Pin ST-P	Notch Pin ST-01P	Long Clamp Pin ST-02P
		
<p>Suitable for measuring small samples such as eye drop lids.</p>	<p>Suitable for firmly fixing samples such as connectors made of resin.</p>	<p>Suitable for clamping samples such as nozzle caps.</p>

* Pins and Spare rubbers are sold in set of 4.

[Dimensions]

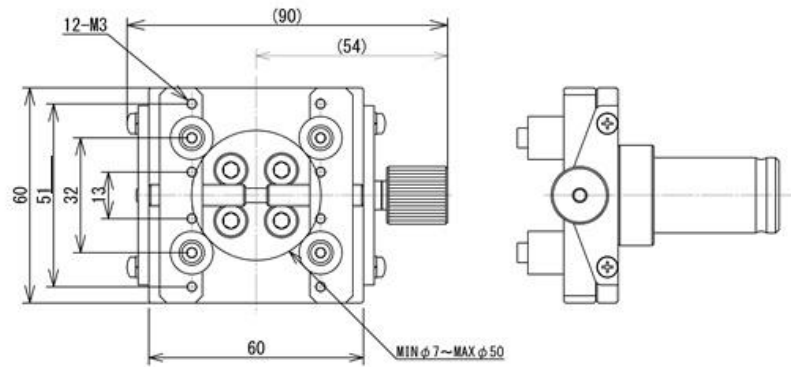

Pins

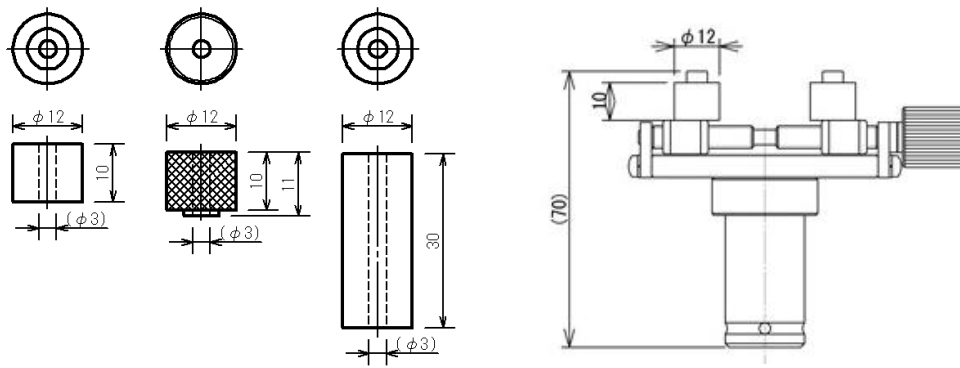

Unit: mm

■ Pin Chuck

	Feature
	<p>The three claws clamp samples such as wire and round-bar samples.</p>

[Specifications]

Model	MT-DC-4	MT-DC-6.5	MT-DC-6.5SUS	MT-DC-13
Capacity	5N-m	10N-m	10N-m	10N-m
Opening width	φ0.5~4mm	φ0.5~6.5mm	φ0.5~6.5mm	φ1.2~13mm
Weight	Approx.170g	Approx.270g	Approx.270g	Approx.650g
Material	Steel	Steel	Stainless-steel (*)	Steel

* We recommend using the stainless-steel chuck under the circumstance making metal rust.

[Dimensions]

MT-DC-4

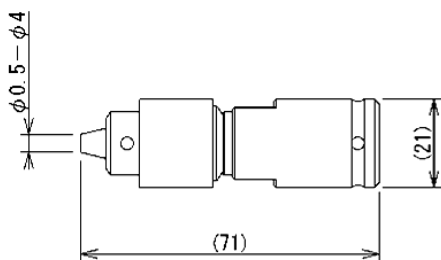

MT-DC-6.5/ MT-DC-6.5SUS

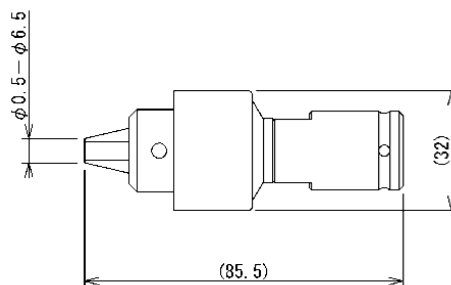

MT-DC-13

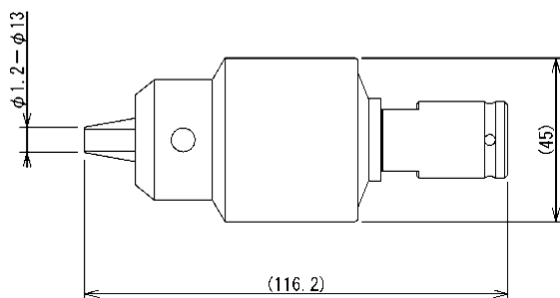

Unit: mm

■ M10 adapter

	Feature
	<p>The adapter for mounting an original jig by the customers. The customers can use their own jig to measure torque.</p>

[Specifications]

Model	MT-AD-M10
Screw	M10×L20
Weight	Approx.50g

[Dimensions]

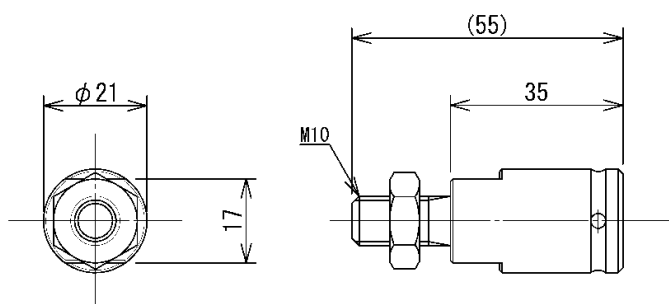

Unit: mm

[Cautions]

- Information in this document is subject to change without prior notice.
- This document is product descriptions and handling precautions, and do not guarantee various characteristics or safety.
- This product is designed for force measurement purpose only.
- Do not copy and use this content without authorization.
- Some samples may not be suitable to measure with this product.

IMADA CO., LTD

99 Jinnoshinden-cho aza Kanowari Toyohashi
 Aichi Japan 441-8077
 Tel: +81-(0)532-33-3288
 Fax: +81-(0)532-33-3866
 E-mail: info@forcegauge.net
 Website: <https://www.forcegauge.net/en/>



Visit our website for more information on a wide range of product specifications, measurement applications and videos.