

Tensile Adhesion Test Jig TATJ-5000N

A Jig designed for the Adhesive Bonding Strength Measurement

Possible to conduct measurements partially complying with JIS K 6849 (1994)

The centering mechanism enables uniform and perpendicular load application for the measurement accuracy

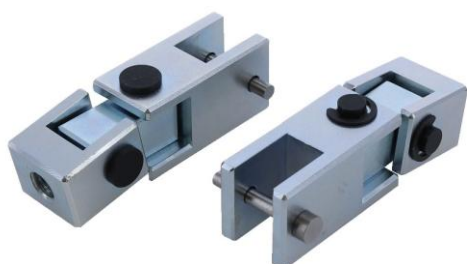

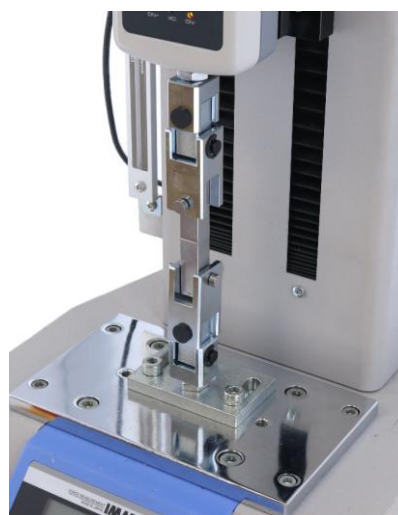

TATJ-5000N 1 set (2pcs)



TATJ-5000N Testing Image

Related Standards

JIS K 6849 (1994) [Testing methods for tensile strength of adhesive bonds]
(corresponding part only)

Measuring Procedures		
Set jigs (Upper and Lower sides)	Install adhered test piece	Apply Tensile Force to pull apart
		

Specifications	
Model	TATJ-5000N
Capacity	5000N
Dimensions	See [Dimensions]
Weight (1. pc)	Approx. 250g
Mounting Screw	M10

- 1set includes 2pcs: Upper and lower jigs.
- Weight of the attachment installed added as load applied to the force gauge.
The total weight is checked prior to the force gauge capacity selection for individual measurements.

Test Piece (Sample Specimen) for JIS K 6849 (1994): available for purchase from IMADA				
Image	Model	Shape	Dimensions	Quantity
	TATJ-TPR	round bar	φ12.7mm × 38mm Hole: φ4.5-1 (+0.05-0.02)	**10 pcs (5sets)
	TATJ-TPS	square bar	12.7mm × 12.7mm × 38mm Hole: φ4.5-1 (+0.05-0.02)	**10 pcs (5sets)



- For every measurement, 1set (2pcs) of sample specimen is required.
- ** For tests complying with JIS K 6849 (1994), min. 5sets of samples required for testing (2pcs bonded at the middle as 1 set x 5sets required).

Example of Product Configuration TATJ-5000N	
<p>Configuration 1 Code: 1T2006A</p> <p>Tensile Adhesive Tests up to 5000N Partly Compliant with JIS K 6849 (1994): Testing methods for tensile strength of adhesive bonds Caters up to 5000N</p> <p>Digital Force Gauge: ZTS-5000N Motorized Test Stand: MX2-5000N Optional Attachment: TATJ-5000N Optional Dedicated Cable: CB-528</p>	 <p>TATJ-5000N Code: 1T2006A Configuration 1</p>
<p>Configuration 2 Code: 1T2006B</p> <p>Tensile Adhesive Tests up to 1000N Partly complies with JIS K 6849 (1994): Testing methods for tensile strength of adhesive bonds Caters up to 1000N</p> <p>Digital Force Gauge: ZTS-1000N Motorized Test Stand: MX2-1000N Optional Attachment: CA-F6T10 Optional Attachment: TATJ-5000N Optional Dedicated Cable: CB-528</p>	

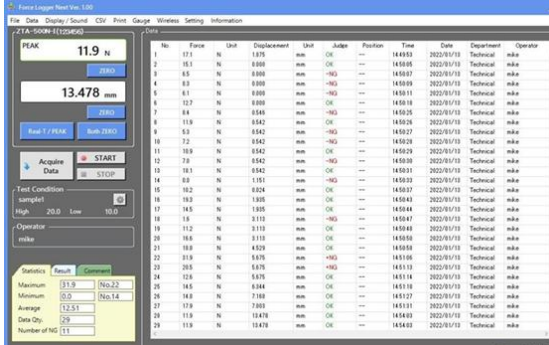
- Refer to the specification of each product for details.
- Product configuration varies depending on the shape and characteristic of the sample, and measurement conditions.
- Note that the load may exceed 5000N.
- The recommended capacity of force gauge varies depending on the expected force to be loaded.

Pressure Conversion Function	Peel/Pressure Data Import Function
	
<p>A pressure conversion function is available for installment to the force gauge, helps with productivity improvement in the inspection process. The force value is automatically converted and displayed in pressure units. Units: Pa / kPa / N/m², etc. available for selection. The function can directly send data in pressure units into the software the “Force Logger Next (downloadable)” available with the “Peel/Pressure Data Import Function”.</p>	<p>For management of the peel force/pressure data, the Peel/Pressure Data Import Function is available for download to the Force Logger Next, to enable measurement data imports in peel force units (N/cm, N/10mm, kN/m, etc.) and pressure units (Pa, kPa, N/m², etc.)</p>

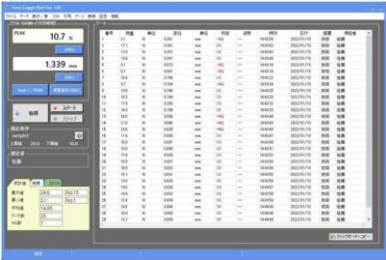
IMADA Connected, User registration and product registrations required for using **Pressure Conversion Function** and **Peel/Pressure Data Import Function**

Related Products		
Software Force Logger Next	Conversion Adapter CA series	Coating Surface Peel Test Fixture TH series
<p>Downloadable data acquisition software, available with Next series force gauges. Enables downloading to display the measurement peak values and continuous data results on your PC.</p>	<p>The screw diameter conversion adapter enables adjusting and converting screw fixture fitting sizes for measuring instruments, etc.</p>	<p>The coating surface peel test fixture for maximum capacity at 5000N. Enable measurements partly comply with JIS and ISO standards.</p>
		

[Dimensions]

TATJ-5000N

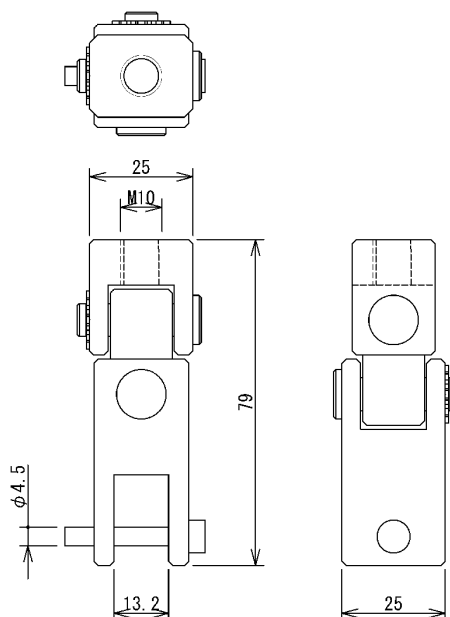

Unit: mm

[Cautions]

- Information in this document is subject to change without prior notice.
- This document is product descriptions and handling precautions, and do not guarantee various characteristics or safety.
- This product is designed for force measurement purpose only.
- Do not copy and use this content without authorization.
- A force gauge (sold separately) is required to use this product.
- Some samples may not be suitable to measure with this product.

IMADA CO., LTD

99 Jinnoshinden-cho aza Kanowari Toyohashi

Aichi Japan 441-8077

Tel: +81-(0)532-33-3288

Fax: +81-(0)532-33-3866

E-mail: info@forcegauge.net

Website: <https://www.forcegauge.net/en/>



Visit our website for more information on a wide range of product specifications, measurement applications and videos.