

## Attachments for HTGS/HTGA series

Exchangeable attachments for Torque Gauges.  
It helps various torque measurement such as screws, bolts and the sample durability.

A wide range of attachments are available to support various measurements.



Small Table



Light Weight Wide Table



Pin Chuck



Socket holder



Torque driver



M10 Adapter

The same attachments can be fixed to the eHT series and SDT series to measure torque.



HTG series  
eHT series (Indicator is sold separately)



Setting image







SDT series



Setting image

### Small Table (For 2/5N-m range)

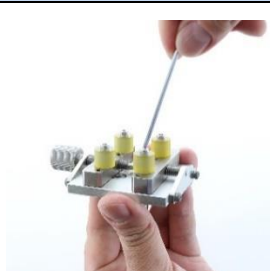

Table	Pin	Feature
 Small Table  Capacity: 5N-m Allowable Sample Diameter: $\phi 7 \sim 50$ mm Weight: Approx.300g Material: Steel and Aluminum	 Standard Pin  Suitable for measuring small samples such as eye drop lids.  Pin weight: Approx.3g/pcs Pin material: Aluminum and Urethan	
	 Notch Pin  Ideal for firmly fixing samples such as connectors made of resin.  Pin weight: Approx.10g/pcs Pin material: Stainless-steel	
	 Long Clamp Pin  Ideal for fixing slim samples such as cosmetic containers.  Pin weight: Approx.8g/pcs Pin material: Aluminum and Urethan	

\* Small table and pins cannot be used for 0.5N-m range.

### [Product Models]

Set	Pin	Model
Small Table + Pins	Standard Pin	HT-ST
	Notch Pin	HT-ST-01
	Long Clamp Pin	HT-ST-02
Pins	Standard Pin	ST-P
	Notch Pin	ST-01P
	Long Clamp Pin	ST-02P

\* 4 pins as a set is sold.





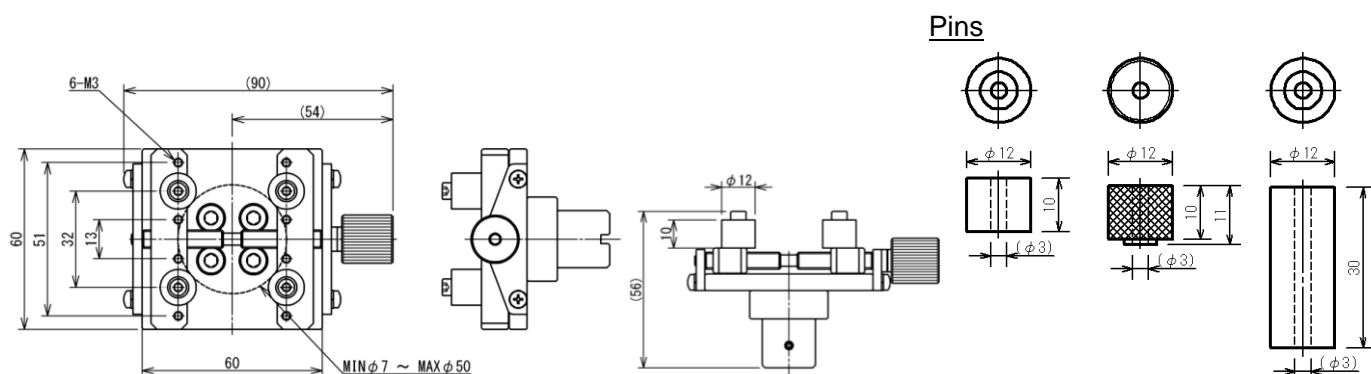



Test image		
 Step 1: Screw the pins.	 Step 2: Fix the sample.	 Step 3: Turn the sample to measure torque.

### [Dimensions]



Unit: mm

**Light Weight Small Table (For 0.5/2N-m range)**

Table	Pin	Feature
 Light Weight Small Table  Capacity: 2N-m Allowable Sample Diameter: φ7~50mm Weight: Approx.150g Material: Aluminum	 Standard Pin	Suitable for measuring small samples such as plastic tubes.  Pin weight: Approx.3g/pcs Pin material: Aluminum and Urethan
	 Notch Pin	Ideal for firmly fixing samples such as small motors.  Pin weight: Approx.10g/pcs Pin material: Stainless-steel
	 Long Clamp Pin	Ideal for fixing slim samples such as cosmetic containers.  Pin weight: Approx.8g/pcs Pin material: Aluminum and Urethan
 Light Weight Wide Table  Capacity: 2N-m Allowable Sample Diameter: φ10~100mm Weight: Approx.200g Material: Aluminum	 Standard Pin	Suitable for measuring samples such as volume dials.  Pin weight: Approx.3g/pcs Pin material: Aluminum and Urethan
	 Notch Pin	Ideal for firmly fixing samples such as motors.  Pin weight: Approx.10g/pcs Pin material: Stainless-steel
	 Long Clamp Pin	Ideal for fixing long and wide samples such as bottle shaped containers and diapers.  Pin weight: Approx.8g/pcs Pin material: Aluminum and Urethan

**[Product Models]**

Set	Pin	Model
Light Weight Small Table + Pin	Standard Pin	HT-STL
	Notch Pin	HT-STL-01
	Long Clamp Pin	HT-STL-02
Light Weight Wide Table + Pin	Standard Pin	HT-STLW
	Notch Pin	HT-STLW-01
	Long Clamp Pin	HT-STLW-02
Pin (*1)	Standard Pin	ST-P
	Notch Pin	ST-01P
	Long Clamp Pin	ST-02P

\* 4 pins as a set is sold.

\*1 The pins of the light weight table is the same as the pins of the small table (P2).

**[Dimensions]**

HT-STL

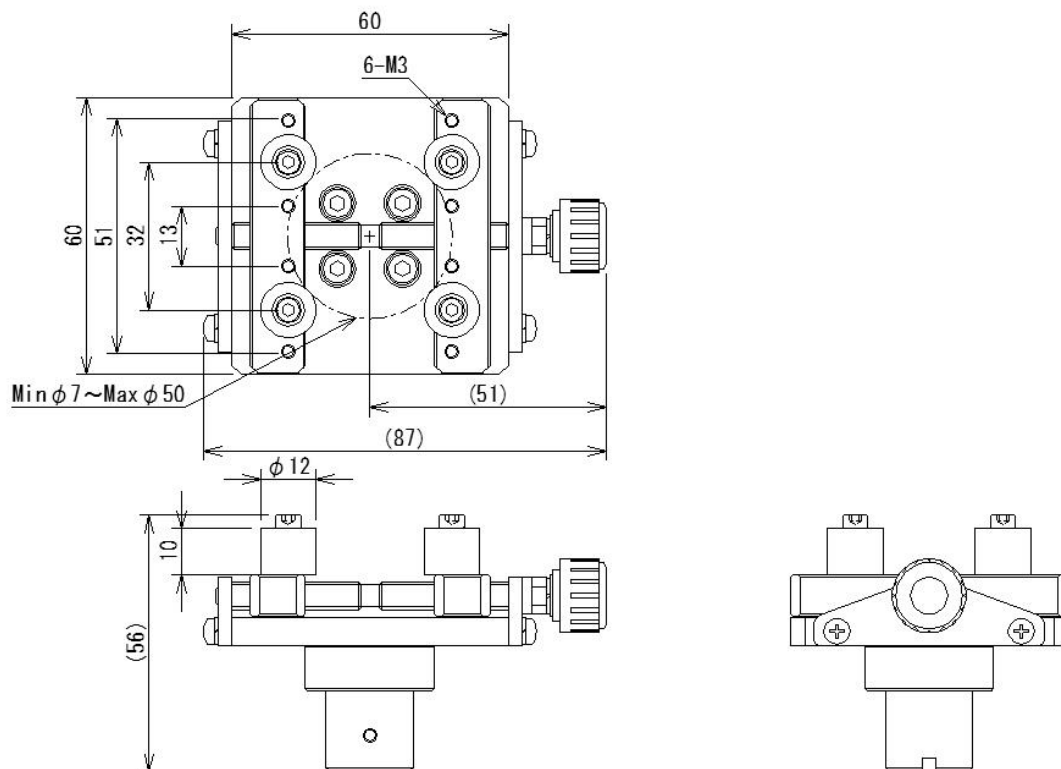

HT-STLW

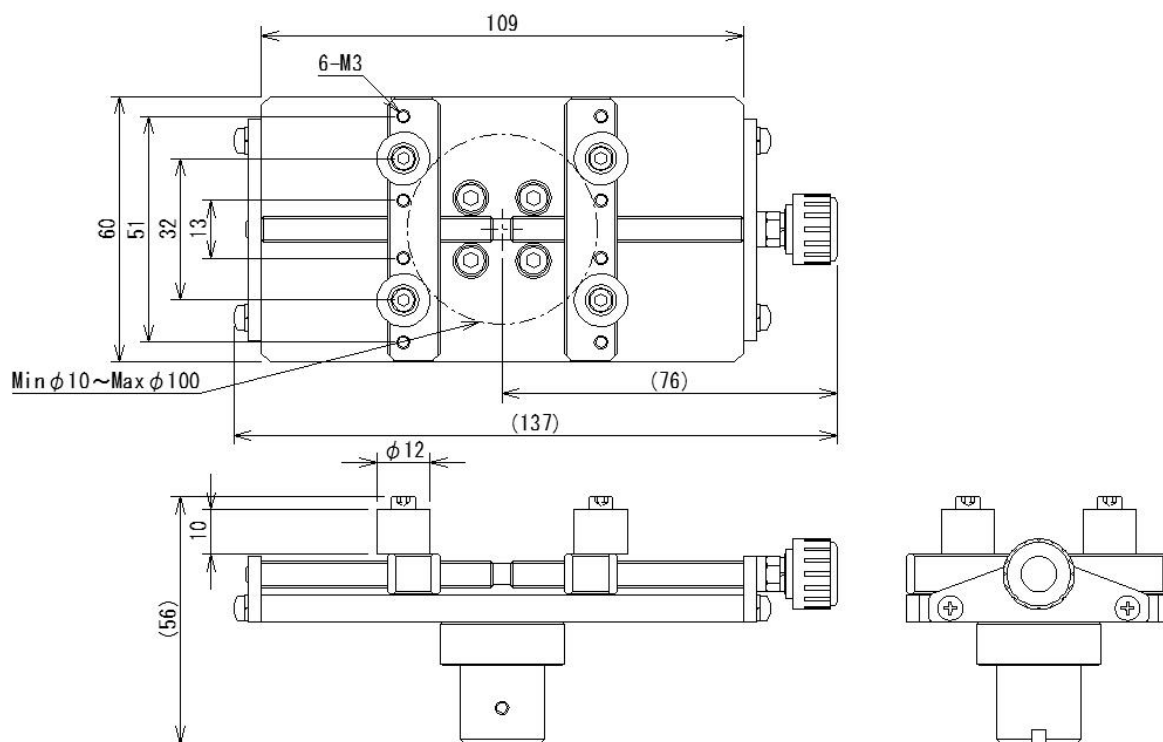

Unit: mm

### Pin Chuck

	Feature
	The three claws clamp samples such as wire and round-bar samples.



### [Specifications]

Model	HT-DC-4	HT-DC-6.5 (*1)	HT-DC-6.5SUS (*1)	HT-DC-13 (*2)
Maximum torque	5N-m	10N-m	10N-m	10N-m
Opening width	φ0.5~4mm	φ0.5~6.5mm	φ0.5~6.5mm	φ1.2~13mm
Weight	Approx.100g	Approx.200g	Approx.190g	Approx.600g
Material	Steel	Steel	Stainless-steel (*3)	Steel

\*1 HT-DC-6.5 and HT-DC-6.5SUS cannot be used for HTGS/HTGA/eHT-0.5N.

\*2 HT-DC-13 cannot be used for HTGS/HTGA/eHT-0.5/2N.

\*3 We recommend using the stainless-steel chuck under the circumstance making metal rust.

Test image		
		
Step1: Mount the pin chuck on the torque sensor.	Step 2: Hold the sample. Turn the sleeve and tighten the sample with the included chuck key.	Step 3: Twist the holding sample and measure the torque.

### [Dimensions]

#### HT-DC-4

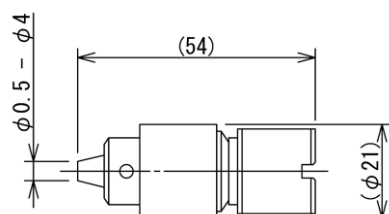

#### HT-DC-6.5/ DT-DC-6.5SUS

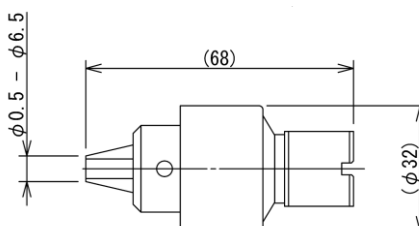

#### HT-DC-13

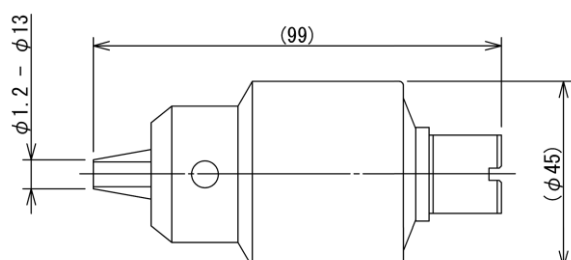

Unit: mm

### Socket holder

	Feature
	Enables to measure torque by connecting a tools such as a driver bits and wrenches etc.

### [Specifications]

Model	HT-9.5SQ
Socket	9.5mm square
Weight	Approx.100g



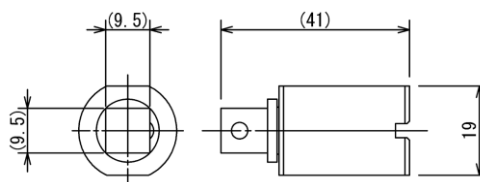

\* Socket holder cannot be used for 0.5N-m range.

### [Dimensions]



Unit: mm

### Test image

			
Step 1: Prepare a 9.5mm square socket wrench.	Step 2: Mount the socket wrench on the socket holder.	Step 3: Mount the Step 2 socket holder on the torque sensor.	Step 4: Twist a bolt with the socket wrench and measure the torque.

### Torque driver

	Feature
	Measure tighten and loosen screw torque with the included screwdriver bit. 6.35mm bit can be installed.

### [Specifications]

Model	HT-DBH *1	HT-DBH-P *2
Bit	⌀1⌀2⌀3x⌀6x45mm	⌀00x50mm
Weight	Approx.100g	Approx.12g

\*1 HT-DBH cannot be used for 0.5N-m range.

\*2 HT-DBH-P is only for 0.5N-m range.

### [Dimensions]

#### HT-DBH

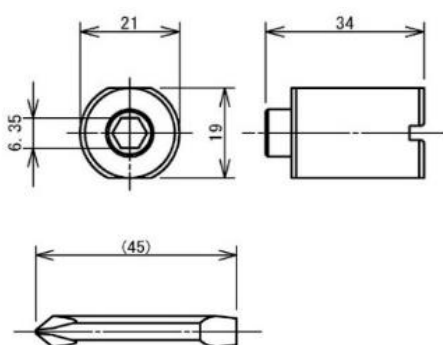

#### HT-DBH-P

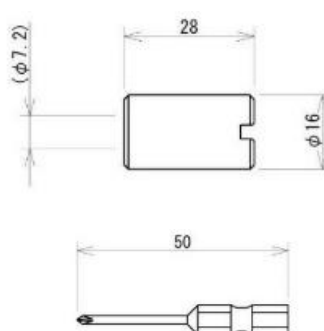

Unit: mm

### M10 adapter

	Feature
	<p>The adapter for mounting an original jig by the customers.          The customers can use their own jig to measure torque.</p>

### [Specifications]

Model	HT-AD-M10
Screw	M10×L20
Weight	Approx.50g

### [Dimensions]

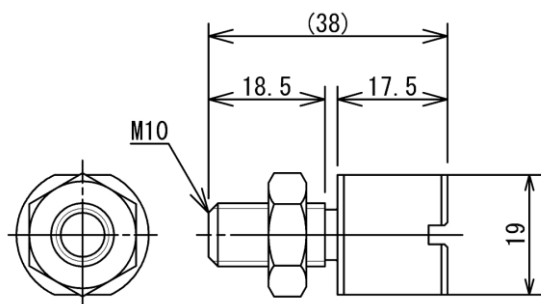

Unit: mm

### [Cautions]

- Information in this document is subject to change without prior notice.
- This document is product descriptions and handling precautions, and do not guarantee various characteristics or safety.
- This product is designed for force measurement purpose only.
- Do not copy and use this content without authorization.
- Some samples may not be suitable to measure with this product.

#### IMADA CO., LTD

99 Jinnoshinden-cho aza Kanowari Toyohashi  
 Aichi Japan 441-8077  
 Tel: +81-(0)532-33-3288  
 Fax: +81-(0)532-33-3866  
 E-mail: [info@forcegauge.net](mailto:info@forcegauge.net)  
 Website: <http://www.forcegauge.net/en/>



Visit our website for more information on a wide range of product specifications, measurement applications and videos.